

1/6 Beasley Avenue Werribee VIC

3 2 2

This modern and stylish townhouse offers the new owner the luxury of a high-end home with a dynamite location to match. With Werribee Train Station, CBD, and its abundance of shops and restaurants only 300m away, everything you could want or need is within walking distance. A very convenient location. 300m to Train Station, with easy access to public transport, Werribee Town Centre and walking tracks along the Werribee River.

- ? Master bedroom with walk in robe and ensuite
- ? Remaining bedrooms both with built in robes
- ? Reverse living with an open plan kitchen, meals and living arrangement upstairs
- ? Kitchen equipped with 900mm oven and 40mm stone bench tops
- ? Central bathroom positioned downstairs servicing the 2 bedrooms

Price : \$ 545,000
Land Size : 136 sqm
View : <https://www.ypa.com.au/7922006>



Mitch Smit
 0450 913 513



James Christou
 0450 733 302

1/6 Beasley Avenue, WERRIBEE

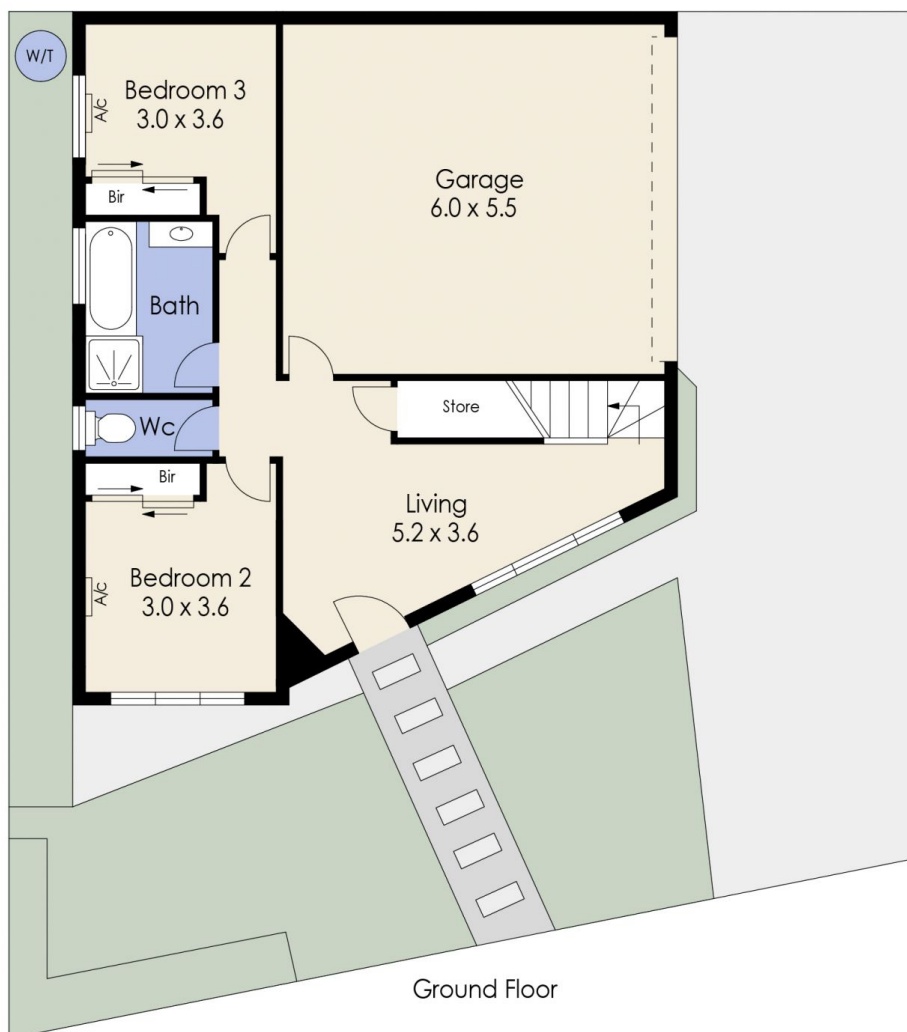

Whilst every attempt has been made to ensure the accuracy of the floor plan contained here, measurements of doors, windows, rooms and any other items are approximate and no responsibility is taken for any error, omission, or mis-statement. This plan is for illustrative purposes only and should be used as such by any prospective purchaser. The services, systems and appliances shown have not been tested and no guarantee as to their operability or efficiency can be given.