



**C1/85 Haines Street North Melbourne VIC**

1 1 1

This serene oasis is the perfect blend of comfort and style featuring 1-bedroom, 1-bathroom and a single secured car park. Nestled in lush green surroundings, the east-facing courtyard offers a tranquil retreat for your morning coffee or evening relaxation on your private timber deck. The updated kitchen consists of electric stainless-steel appliances, brand new cooktop, and elegant stone benches, complimented by a mirrored splashback.

The European laundry discreetly tucked within a bathroom that has floor to ceiling tiles enhancing the modern appeal. Enjoy year-round comfort with a reverse cycle split system and embrace the seamless indoor-outdoor transition with double glazed sliding doors leading to the courtyard. The bedroom is adorned with built-in mirrored robes adding functionality to the space.

**View :** <https://www.ypa.com.au/7920218>



**Bassam Tofaili**  
**0477 972 229**



**Kristen Thompson**  
**0459 972 229**

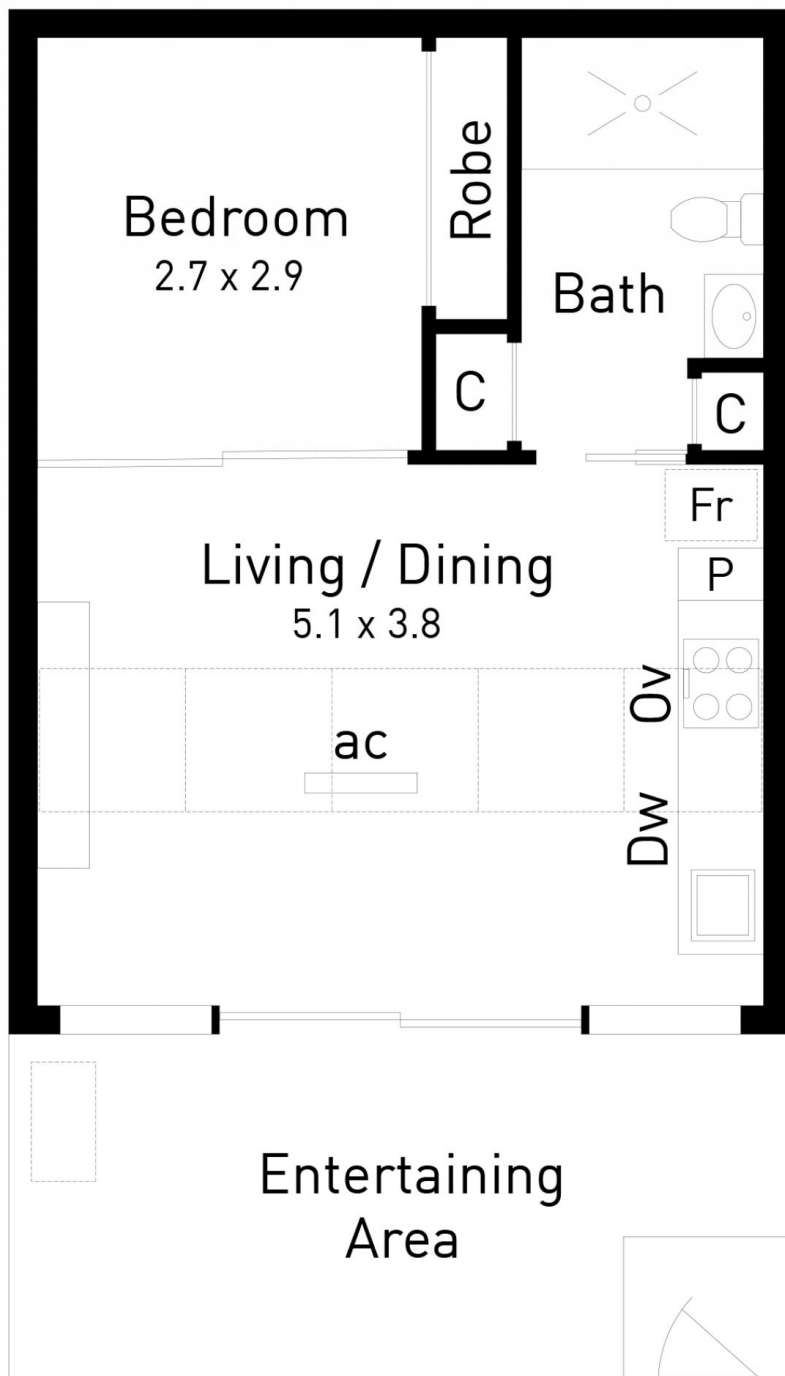

Total Internal Area 35m<sup>2</sup>



C1/85 Haines St, North Melbourne



Disclaimer: Please note this floor plan is for marketing purposes and is to be used as a guide only. This floor plan is intended to give a general indication of the layout only. Any statements of distance, size or area are approximate and for indicative purposes only.