



35 Wittick Street Darley VIC

3 2 2

Nestled in the sought-after Darley neighbourhood, this impeccably maintained residence is strategically positioned near parks, schools, and local shops. Ideal for a young family, first-time homebuyer, or savvy investor, this home impresses with its low-maintenance design and ready-to-go inclusions. Featuring three bedrooms, the well-thought-out floorplan seamlessly integrates an open living and dining area. The kitchen, the heart of the home, is equipped with stainless steel appliances, ample cupboard space, a built-in pantry, and stylish stone top benches.

A separate front lounge bathed in natural light enhances the appeal of multi-zone living. The master bedroom boasts a generously sized ensuite complete with a vanity, shower, and toilet, accompanied by a convenient walk-in robe. The remaining bedrooms are furnished with built-in robes, while a second bathroom offers a full-size bath, shower, and a

Price : \$649,000 - \$709,000
Land Size : 655 sqm
View : <https://www.ypa.com.au/7881169>



Vickie Ramon
0403 194 621



Izabel Dusik
0421 833 010

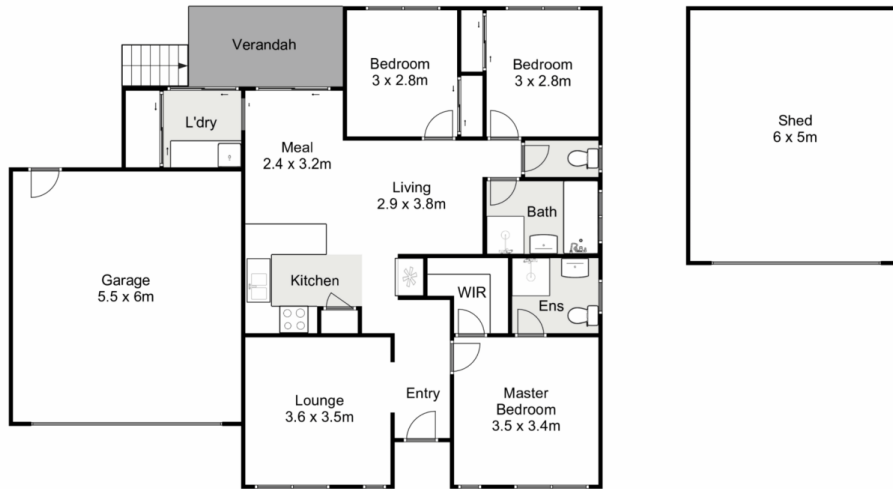

35 Wittick Street, Darley

YPA

Whilst every attempt has been made to ensure the accuracy of the floor plan contained here, measurements of doors, windows, rooms and any other items are approximate and no responsibility is taken for any error, omission, or mis-statement. This plan is for illustrative purposes only and should be used as such by any prospective purchaser. The services, systems and appliances shown have not been tested and no guarantee as to their operability or efficiency can be given.

