



1 Rialto Grove Dromana VIC

3  1  1 

Discover the epitome of tranquil living, surrounded by the soothing embrace of nature in this charming 3-bedroom retreat. Set on a corner block of approximately 704m², it's conveniently located near Boundary Road shops and local bushland, offering easy access to walking trails. This property presents a golden opportunity for future growth and investment, whether through upgrades or extensions.

Inside, you'll find three generously-sized bedrooms, each equipped with built-in robes. The modern bathroom features a spacious rainfall shower and a relaxing bathtub, plus the property offers a separate toilet for added convenience. The well-appointed kitchen comes complete with electric hotplates, an oven, a dishwasher, and ample storage and counter space, making meal preparation a breeze.

Price : \$ 845,000
Land Size : 704 sqm
View : <https://www.ypa.com.au/7790145>



Will Likendey
0448 785 744

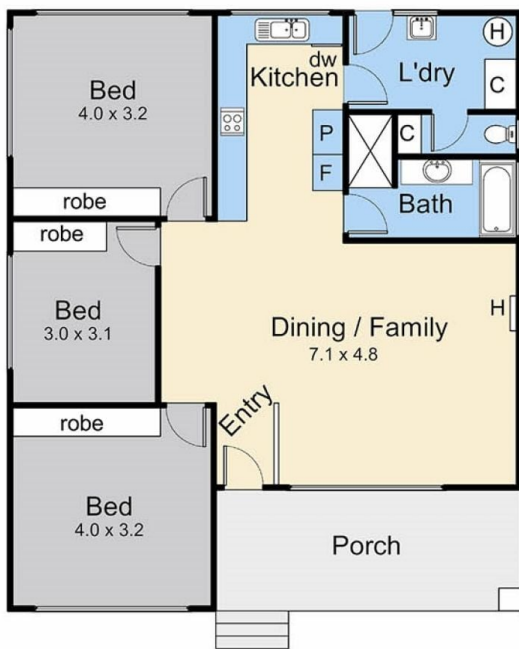

1 Rialto Gve, Dromana

This floorplan is for illustration purposes only and no warranty is given to its accuracy. Purchasers are advised to carry out their own investigations. Produced by **realitywriters (03) 5970 2222**