

## 37 Wallaby Track Beremboke VIC

2 🏠 2 🚗 10 🚗

Introducing an extraordinary property with boundless space and breathtaking panoramic views. This remarkable two-bedroom, two-story residence is set on a sprawling (approx.) 118 acre estate, offering a vista that extends as far as the eye can see, encompassing the picturesque Yu Yang Ranges and the tranquil waters of Port Phillip Bay.

Discover a property filled with potential and stunning views. The open-plan kitchen, dining, and family area offers space for your personal touch. Some finishing work is needed to shape it as you desire. The lower level combines the laundry and bathroom, awaiting your design choices.

Upstairs, two charming bedrooms await. The master bedroom stands out with polished hardwood flooring and panoramic views. It features a cozy sitting area and an ensuite with room for your improvements.

What truly distinguishes this property is its captivating scenery from the bedrooms and living areas. With your

**Price** : Expression Of Interest  
**Land Size** : 118.3 Acres  
**View** : <https://www.ypa.com.au/7786032>



**Shane O'Brien**  
 0431 766 082



Ground Floor

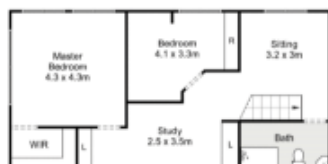

First Floor



## 37 Wallaby Track, Beremboke



Whilst every attempt has been made to ensure the accuracy of the floor plan contained here, measurements of doors, windows, rooms and any other items are approximate and no responsibility is taken for any error, omission, or mis-statement. This plan is for illustrative purposes only and should be used as such by any prospective purchaser. The services, systems and appliances shown have not been tested and no guarantee as to their operability or efficiency can be given.

