



2/537 Melton Highway Sydenham VIC

2  1  1 

Close To All Amenities!

Positioned in a fantastic location of Sydenham this townhouse comprises two fitted bedrooms, central bathroom to service all, ample sized kitchen complete with stainless steel appliances adjacent to family and meals area. Step outdoors, to a low maintenance courtyard easy to maintain all year round. Other features include; single lock up garage, reverse cycle split system and ceiling fans in the bedrooms. Within close proximity to Watergardens Shopping Centre & Train Station, childcares, Sydenham Primary School, Copperfield College, transport and parkland.

Ticking all boxes from the low maintenance lifestyle to being minutes away to all local amenities it's the perfect opportunity for the first home buyer, downsizer or the savvy investor looking to grow their property portfolio.

Price : \$ 440,000

View : <https://www.ypa.com.au/7784066>



**Peter Colella
0421 346 326**



**Monique Cukavac
0449624617**

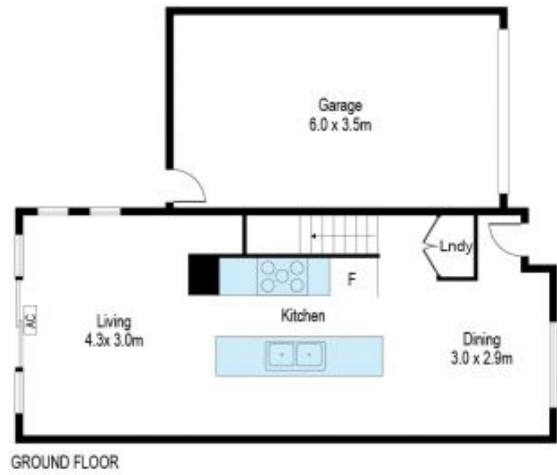

Scale in metres. Indicative only. Dimensions are approximate. All information contained herein is gathered from sources we believe to be reliable. However we cannot guarantee its accuracy and interested persons should rely on their own enquiries

2/537 Melton Hwy, Sydenham