

# YPA



6 Company Road Berwick VIC

4 🚗 2 🚗 1 🚗

Welcome to the finest offering from YPA Cranbourne:

A stunning double-story residence nestled in the vibrant heart of Berwick. Situated just a brief 2-minute stroll from the upcoming Alira Village, a new and exciting shopping centre, and a 5-minute walk to the prestigious Heritage College, this property presents an unbeatable location, with attractions like the Berwick Springs Lake, a 7 minutes away on foot, and convenient proximity to the train station, hospitals, schools, and colleges, this home encapsulates the essence of modern living.

Property Highlights:

- 4 spacious bedrooms featuring built-in wardrobes for your convenience.
- Luxurious hybrid flooring that blends style with easy

**Price** : \$ 755,000

**View** : <https://www.ypa.com.au/7718833>



**Vijay Kumar**  
0431 177 566



**Kamaljeet Singh**  
0433 619 387

Ground Floor

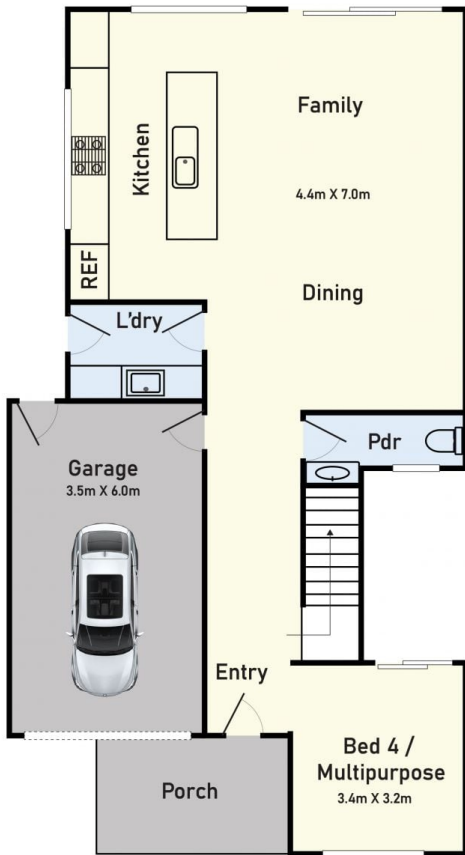

First Floor

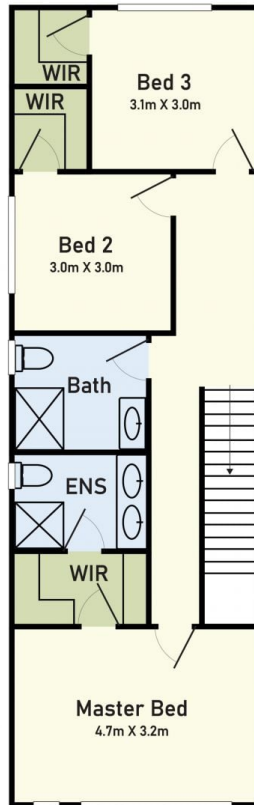

Site Plan

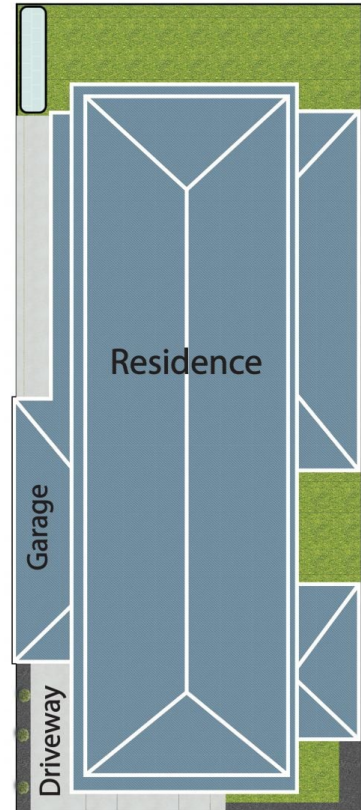

# 6 Company Road, Berwick, VIC 3806

\* Dimensions are approximate and for illustrative purposes only

