

## 42 Overland Dr Doreen VIC

5 🛏 2 🚗 4 🚗

Witness the magnificence of this exquisite residence firsthand. Nestled on a sprawling corner block, this grand family abode offers an impressive living experience.

Perfectly positioned on a generous 804m<sup>2</sup> block of land, this residence boasts impeccable features that grace every inch of its interior. From the expansive butler's pantry to the capacious three-car garage with drive through access, complete with additional space for accommodating a caravan and a boat - every detail has been meticulously crafted. Not to be missed is the stunning outdoor entertainment area with an Albatross iconic pool that is sure to capture your heart.

With a total of five fully robed bedrooms, including two main suites, the residence offers ample space for a large family. The flowing layout encompasses an open-plan dining and

**Price** : \$ 1,350,000  
**Land Size** : 804 sqm  
**View** : <https://www.ypa.com.au/7718510>



**Richard Stockman**  
0414482798



**Carla Primiano**  
0407 183 331

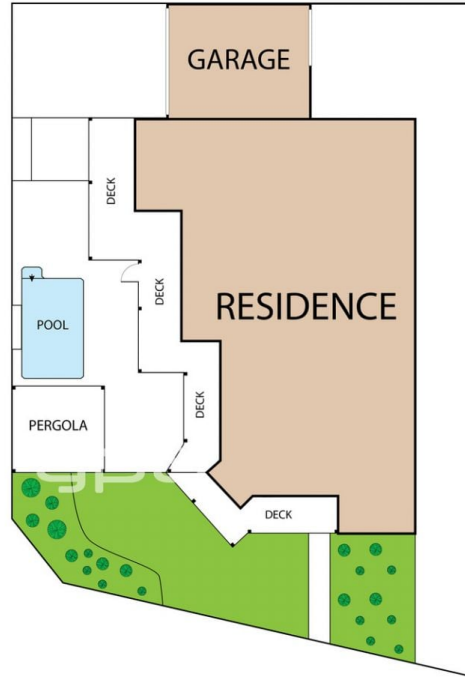

42 Overland Drive, Doreen 3754

Whilst every attempt has been made to ensure the accuracy of the floor plan contained here, measurements of doors, windows, rooms and any other items are approximate and no responsibility is taken for any error, omission, or misstatement. This plan is for illustrative purposes only and should be used as such by any prospective purchaser.