



26 Second Avenue Melton South VIC

3 1 2

. Located in the heart of Melton South close by to all amenities including: all levels of schooling, parks, Melton South Train Station, Melton Station Square, freeway access and so much more.

. This well looked after property comprises of three generously sized bedrooms which are located at the rear of the property and all feature built in robes and are all serviced by the neat and tidy central bathroom which also features a separate toilet.

. Situated at the front of the home is the large family living area perfect for the family movie night. This leads seamlessly into the dining area overlooked by the well-maintained original kitchen which features dishwasher, cooktop and oven and ample bench/ storage space.

. Moving outside the backyard offers amazing space with a large outdoor pergola perfect for entertaining guests and also features a huge yard

View : <https://www.ypa.com.au/7704551>



Jessica Cash
0450 499 446

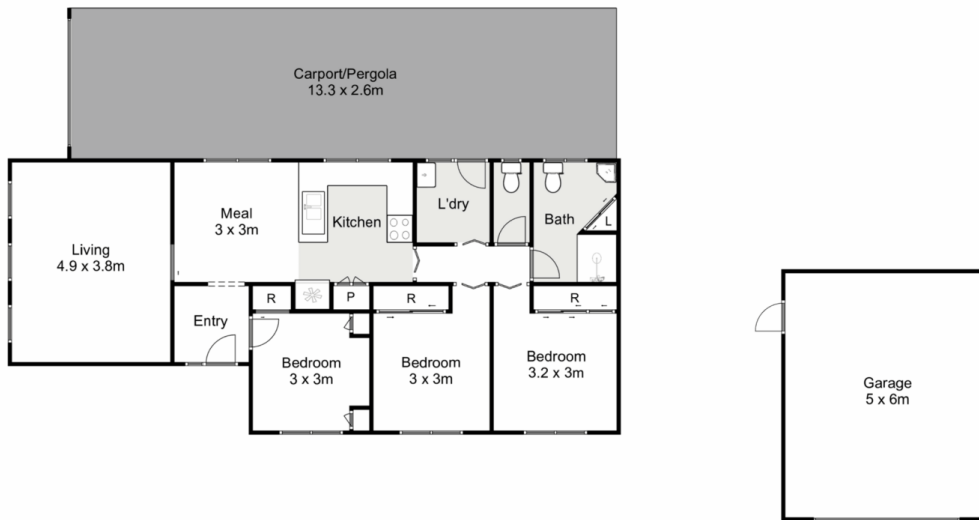

26 Second Avenue, Melton South

YPA

Whilst every attempt has been made to ensure the accuracy of the floor plan contained here, measurements of doors, windows, rooms and any other items are approximate and no responsibility is taken for any error, omission, or mis-statement. This plan is for illustrative purposes only and should be used as such by any prospective purchaser. The services, systems and appliances shown have not been tested and no guarantee as to their operability or efficiency can be given.

