



4/20 Standfield Street Bacchus Marsh VIC

2 1 1

Located in one of the most exclusive areas of Bacchus Marsh township, sits this ideal opportunity for investors, downsizers and first home buyers. Situated in a perfect location, only minutes' walk from shops, schools, Bacchus Marsh Hospital, Bacchus Marsh Train Station and the Bacchus Marsh CBD, this home is a fantastic opportunity for all!

Entering the home you are welcomed into the open plan living/dining area, alongside the functional kitchen, with built-in pantry, ample cupboard/bench space and many more outstanding features.

The home features two great sized bedrooms both with built in robes, a fully functional bathroom complete with toilet, shower bath and sink. Continuing outside, you are met with an undercover pergola area and low maintenance

Price : \$349,000 - \$379,000

View : <https://www.ypa.com.au/7696285>



Mark Edwards
0422 017 068

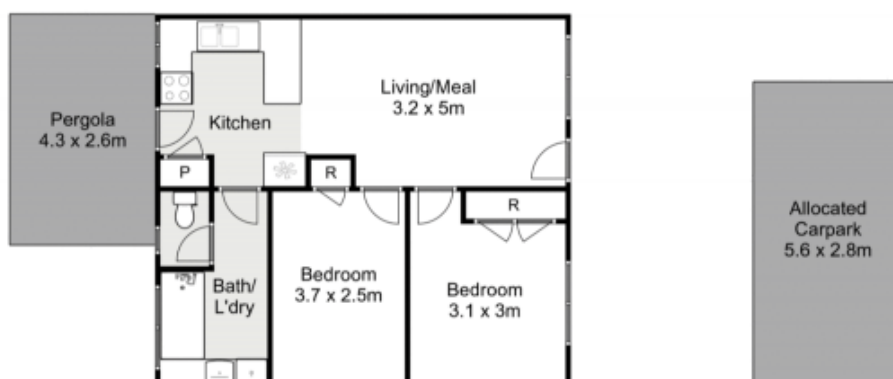

4/20 Standfield Street, Bacchus Marsh



Whilst every attempt has been made to ensure the accuracy of the floor plan contained here, measurements of doors, windows, rooms and any other items are approximate and no responsibility is taken for any error, omission, or mis-statement. This plan is for illustrative purposes only and should be used as such by any prospective purchaser. The services, systems and appliances shown have not been tested and no guarantee as to their operability or efficiency can be given.

