



1/228 Mitchell St NORTHCOTE VIC

3  1  1 

Take advantage of a prime position in a peaceful and family orientated street zoned to Northcote High that presents an incredible lifestyle opportunity waiting to be executed and transform this three bedroom house into your next family home.

**Price** : \$1,050,000 - \$1,150,000  
**Land Size** : 280 sqm  
**View** : <https://www.ypa.com.au/7626357>

Set on approximately 280m<sup>2</sup>, in its original condition this homes interior currently offers three large bedrooms, central bathroom, spacious lounge and original kitchen area. There's also a single lock up garage and rear access. This home is very liveable but ready for its next phase, be that a full renovation and extension to create a family home, perhaps a new home site (STCA). Generously proportioned rooms with high ceilings, a smattering of period features remain to create a blank canvas.

There's a side drive, plus rear access to the deep northerly



**Mel Merhi**  
0402 717 761

## Floor Plan

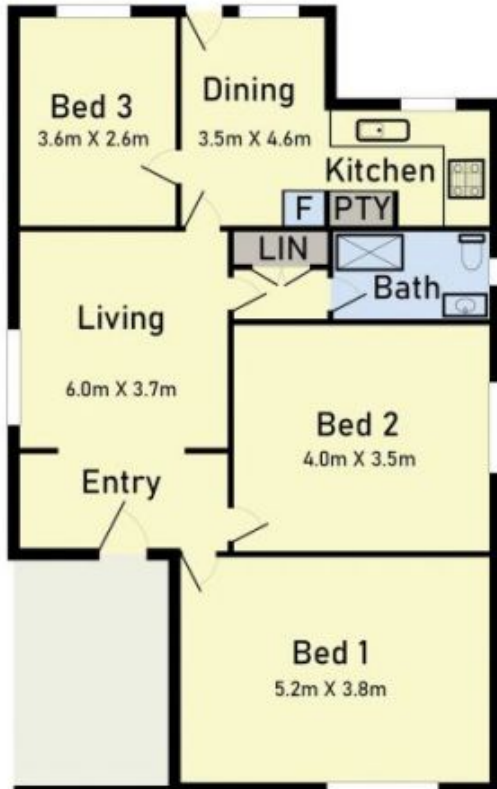

## Site Plan

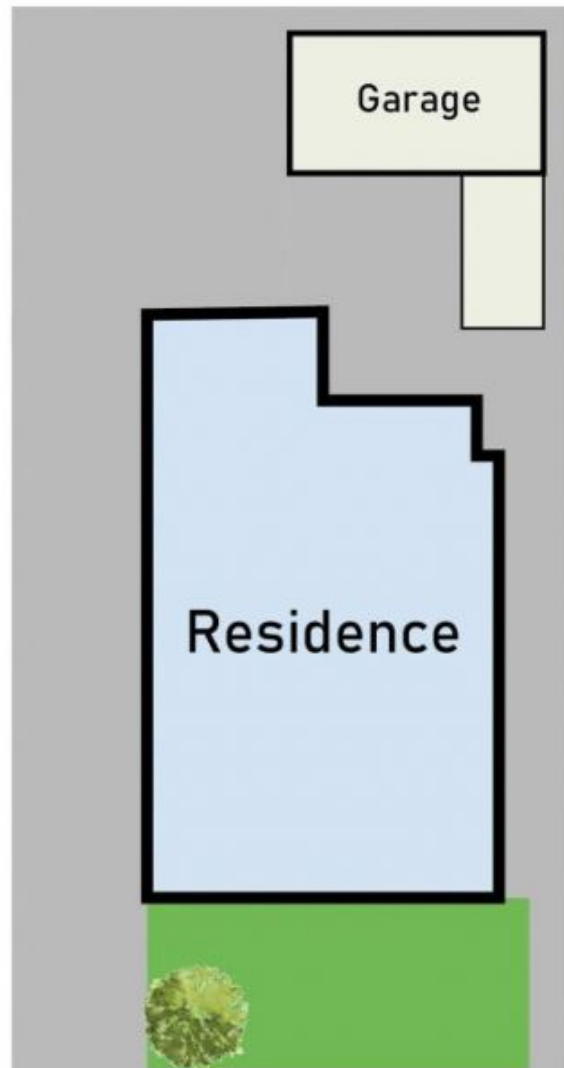

# 1/228 Mitchell Street, Northcote

\* Dimensions are approximate and for illustrative purposes only