



### 3 Adina Street Rye VIC

3  2  2 

A truly magical property located in one of the most sought after and tightly held positions in Rye, 'OCEAN TIDE' boasts an impressive design and a long list of features that make it an exceptionally rare find.

Situated in a peaceful, leafy street and enveloped by mature native vegetation, this beautiful coastal home offers spacious, light filled interiors and an open concept floor plan, plus a huge outdoor entertaining deck and fully landscaped rear garden - making this home a property for all seasons.

Featuring three lovely bedrooms including a generous primary bedroom with ensuite, the home also features a large open plan living room, family room, family bathroom with spa, separate full laundry, and a lovely wrap around deck. Each room also has its own split system air

**Price** : \$ 1,130,000  
**Land Size** : 640 sqm  
**View** : <https://www.ypa.com.au/7528809>



**Jade Springer**  
0437 410 791

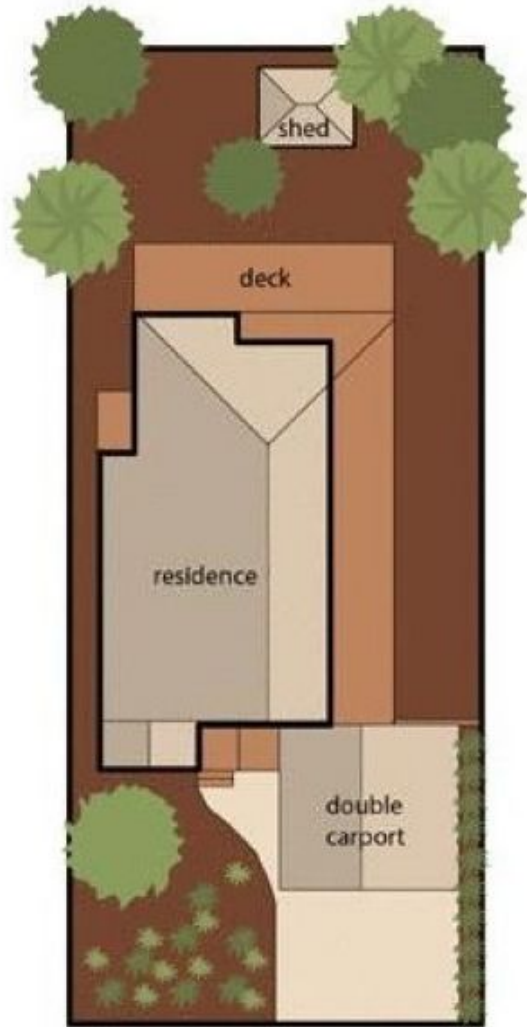

Internal living area  
approx: 15 squares

Carport area  
approx: 3.6 squares

Decking area  
approx: 7 squares

Total: 25.6 squares

## 3 Adina Street, Rye

This floorplan is for illustration purposes only and no warranty is given to its accuracy. Purchasers are advised to carry out their own investigations.