



## 16 Roycroft Avenue Burnside VIC

6 3 2

A rare opportunity has arrived to purchase this unique home. This impressive home enhanced by its elite location offers the ideal family living, the position is perfect adjacent to parklands and only a short stroll to shops, public transport, schools, Ballarat road and within easy access to the freeway.

This home is a must see and is ready to move in with a large welcoming entrance with a large light filled lounge room, three bedrooms with built in robes, master bedroom with walk in robe and full ensuite, a large functional kitchen which offers ample bench space which overlooks the open plan living family & dining area. Added extras include a central bathroom, gas ducted heating, cooling, large pergola perfect for family entertaining all year round and a garden shed.

**Price** : \$ 760,000  
**Land Size** : 601 sqm  
**View** : <https://www.ypa.com.au/7517432>



**Joel Rawle**  
 0416 165 473



**Menka Zdraveska**  
 0404 160 951

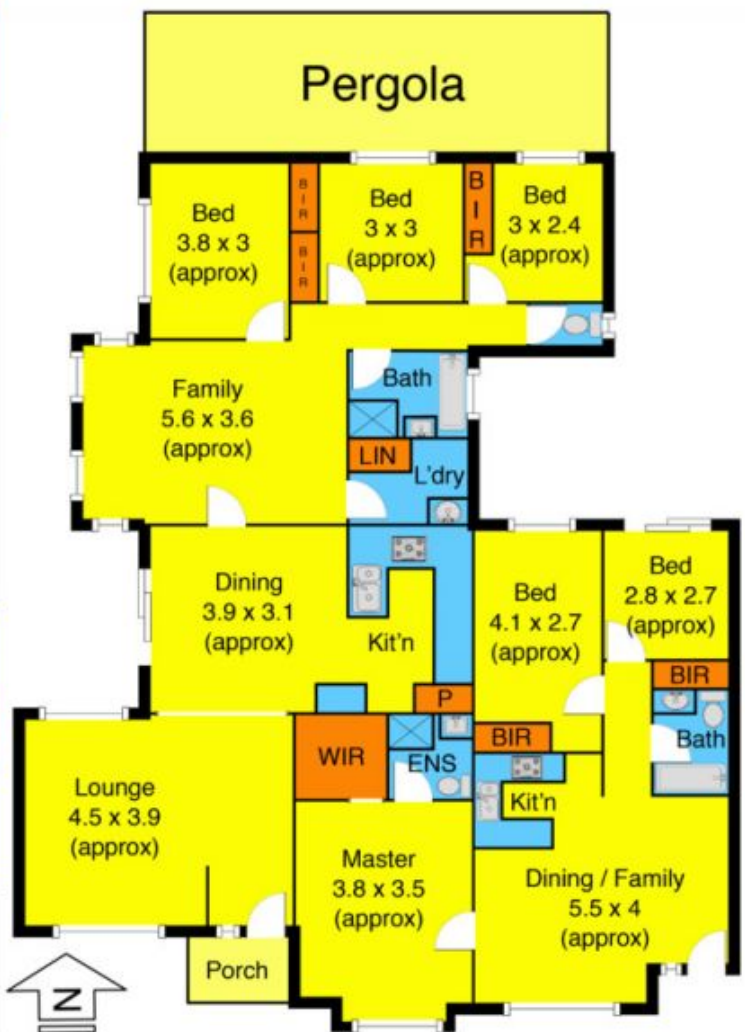
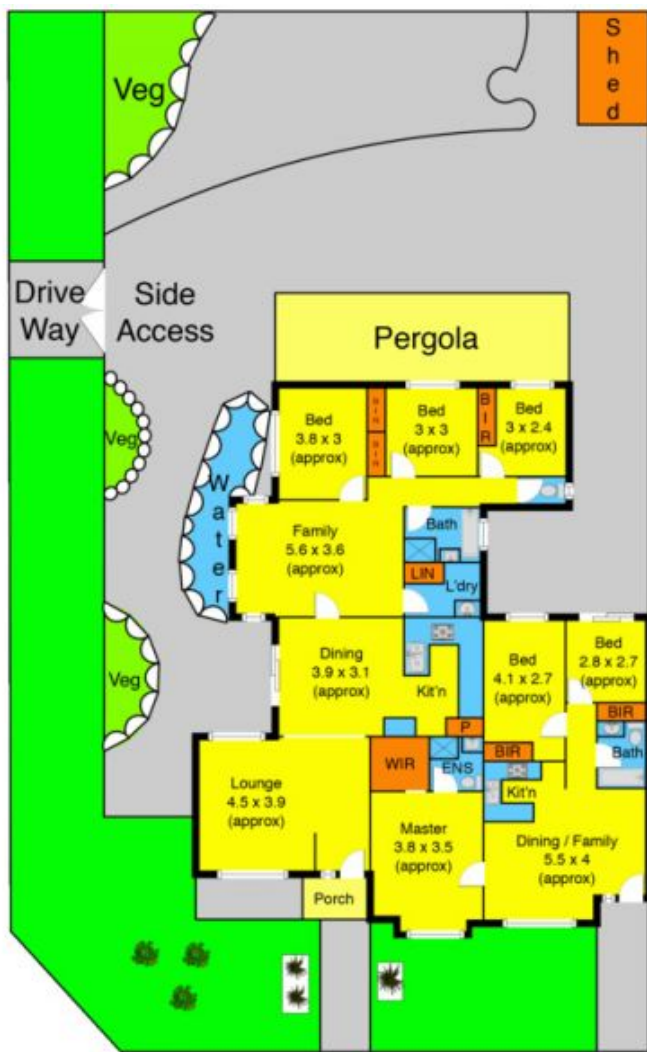

Roycroft Avenue