



5 Cranesbill Lane Mickleham VIC

5 🏠 2 🚗 10 🚗

With one of the most sought-after estates in Mickleham, an ideal escape for those seeking privacy and boundless space yet having all the amenities within walking distance, one look is all it will take to fall in love with this unique offering.

This 2.64 acres (approx) corner block features a dual entrance. The property provides a lifestyle that the whole family will enjoy. The beautiful entrance will entice you as soon as you walk through.

Land Features:

? 4x large, protected River Gum trees approx. 400 years old.

? Established gardens & large central dam full of yabbies, and often home to families of ducks.

Land Size : 2.64 Acres

View : <https://www.ypa.com.au/7516102>



Khaled Khaled
0400 004 556



Abdel Al Bikai
0476 888 808

5 Cranesbill Lane, Mickleham

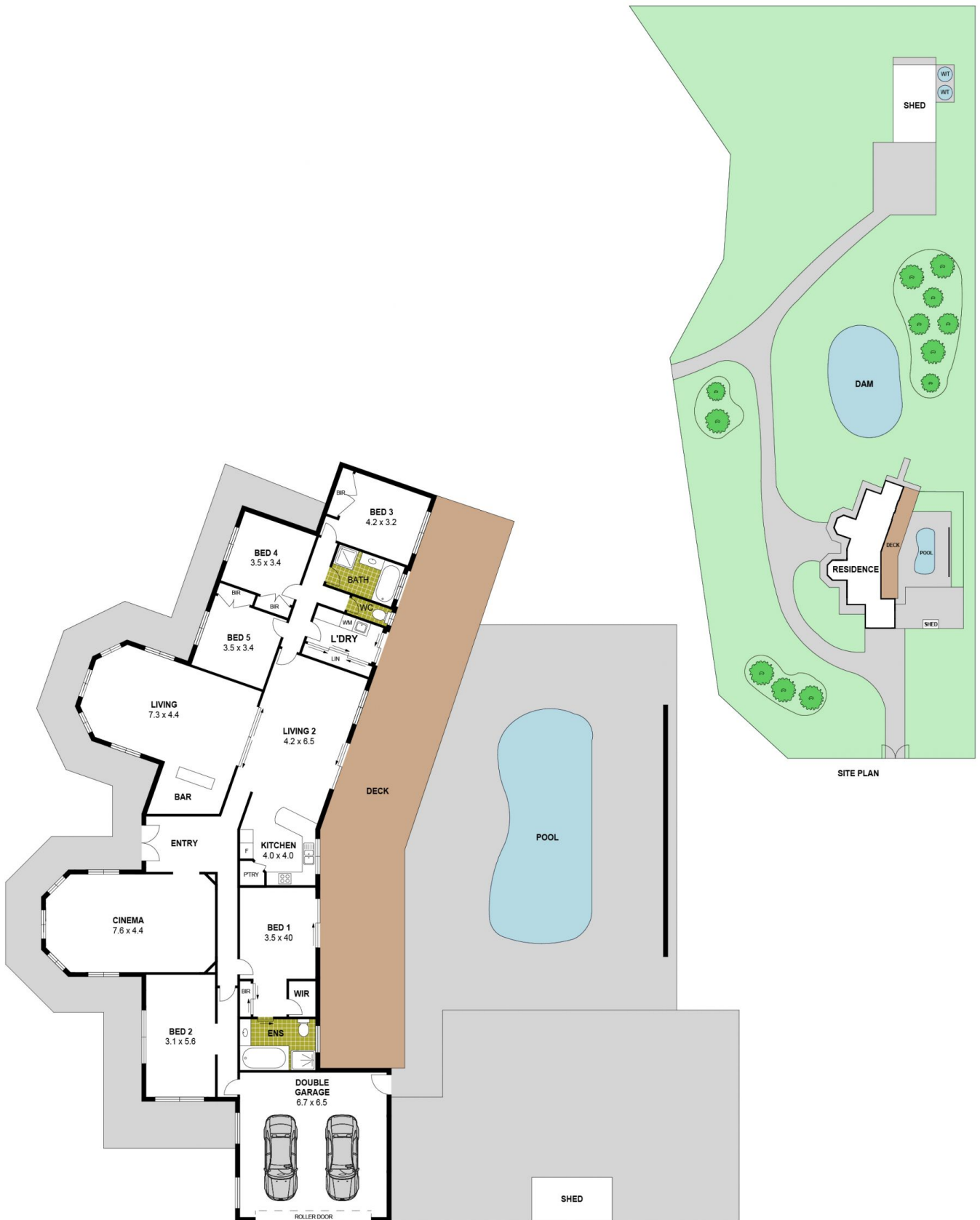

Disclaimer : Whilst every precaution is taken to ensure information provided regarding this property is highly accurate, the measurements are for guidance only and are not to be used for any other purpose. The agency and creators of this illustration deny responsibility for any omissions or errors contained herein, or for practices carried out with further use of these dimensions. Dimensions are taken from the structural walls in each respective room and will be taken on the longest dimension to maintain uniformity across plans.