



## 43 Woolnough Drive MILL PARK VIC

4 3 2

Introducing this large two-story home in a quiet area of Mill Park, situated on a generous 1176m2 (approximate) lot. Upon entering, there is a sizable living room with space for several visitors, a separate dining area, a good-sized kitchen, a powder room, and ducted heating and conditioning throughout. There is a sizable basement area on the ground floor as well, which has numerous applications for people who need more room.

Three spacious bedrooms-two with built-in closets and one with a walk-in closet and a full bathroom-as well as a second open living space with a separate kitchen, living room, and dining area are located on the second floor. This level also offers a number of different living possibilities. The entire back of the second story is covered by a spacious balcony, which offers a tranquil and welcoming

**Price** : !!Contact Agent!!  
**Land Size** : 1176 sqm  
**View** : <https://www.ypa.com.au/7486541>



**Tannous Kabalan**  
**0401619618**



**Mel Merhi**  
**0402 717 761**

## Ground Floor

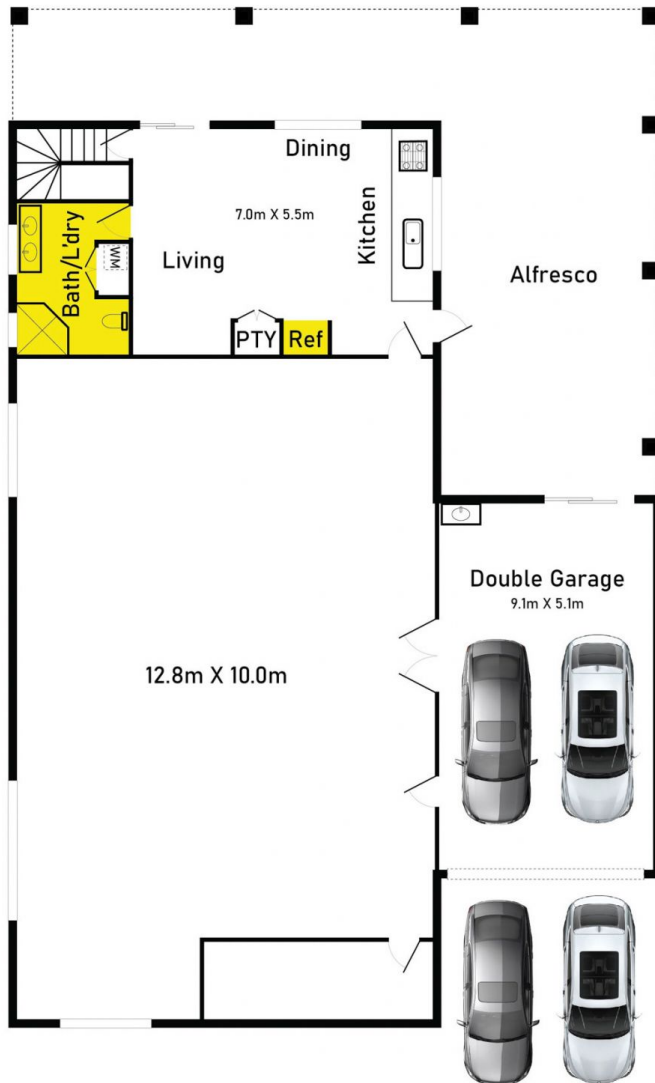

## First Floor

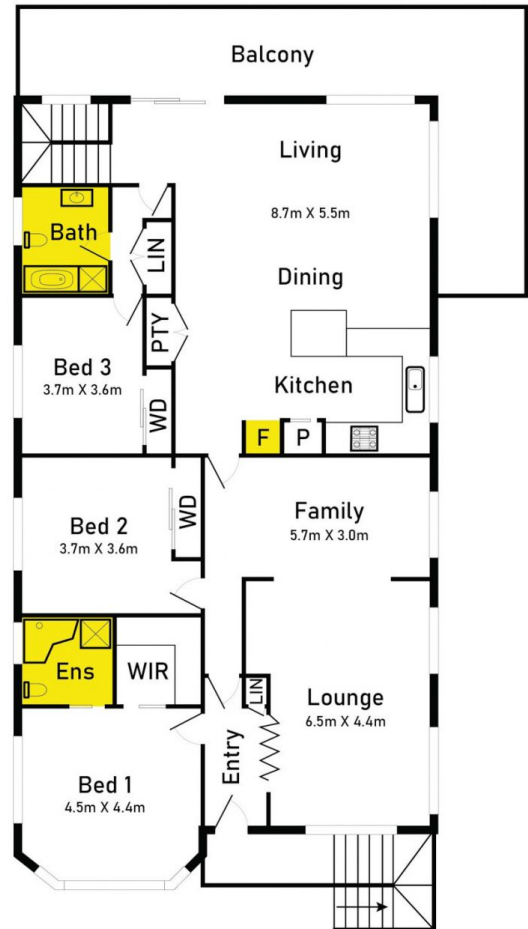

# 43 Woolnough Drive, Mill Park

\* Dimensions are approximate and for illustrative purposes only