



68 Bamford Avenue Westmeadows VIC

3  1 

Introducing 68 Bamford Avenue, a stunning turnkey property located in the most coveted part of Westmeadows. This contemporary home is designed to offer effortless living and a modern lifestyle, perfect for families or couples looking for a stylish and functional space to call their own.

Featuring open-plan kitchen, living and dining area, this property basks in natural light and has seamless flow from indoors to the outdoor spaces. The modern kitchen is sure to impress, complete with a large stone island bench, 900mm Smeg oven and ample storage, perfect for entertaining guests or preparing delicious meals for the family.

This property also features three spacious bedrooms, each with ample storage and natural light. The central bathroom is modern and sleek, while a separate laundry adds to the

Price : \$ 765,000
Land Size : 545 sqm
View : <https://www.ypa.com.au/7486217>



Luke Albioli
0403 700 003



Jeremy Pate
0428 085 280

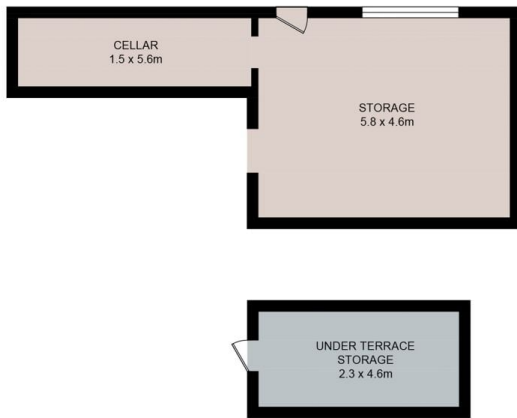

Cellar & Storage



Ground Floor

68 Bamford Ave, Westmeadows

Disclaimer: Floor plan is for marketing purposes and is to be used as a guide only. Measurements are approximate and for illustrative purposes. Interested parties should make and rely on their own enquiries or refer to contract drawings for more accurate information.