



1 Dorothea Crescent Dromana VIC

3  2  2 

This Brick & Timber Home has Great Potential to Add Value but it is very liveable as is! The home is split into upstairs and downstairs living, ideal for the extended family!

Price : \$ 814,000
Land Size : 528 sqm
View : <https://www.ypa.com.au/7472543>

Featuring:

Upstairs:

- ? 2 Bedrooms with Built-in Robes
- ? Lounge room taking advantage of the Bay Views
- ? Wrap around Balcony
- ? Family Bathroom



Elke Remscheid
0423 211 315



Melissa Remscheid
0432 923 703

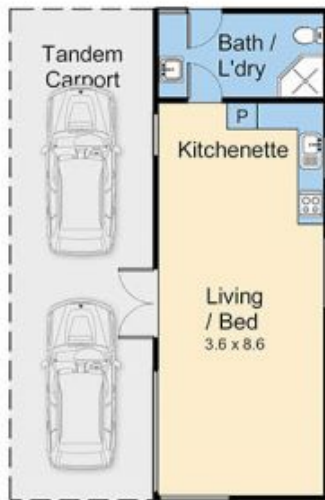
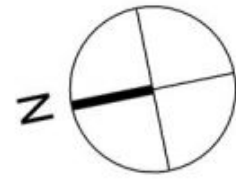

Lower Floor



Upper Floor



Site Plan

Dorothea Crescent

1 Dorothea Crescent, Dromana

This floorplan is for illustration purposes only and no warranty is given to its accuracy. Purchasers are advised to carry out their own investigations. Produced by **realitywriters** (03) 5970 2222