



## 44 Koala Crescent Westmeadows VIC

3  2  2 

Surrounded by peaceful parklands, this light-filled family prize delivers a leafy lifestyle on a considerable 785sqm\* parcel.

A classic '70s façade reveals a smart and spacious interior with multiple living areas and abundant storage throughout. A stylish main bathroom with an individual bath and shower, compliment a trio of generous bedrooms with built in robes. The home is met by a sizeable lounge with wood heater, a dedicated study area, an open family/dining zone and bi-folds which merge indoor and outdoor living. Acres of creekside trees paint a tranquil backdrop to sun-soaked afternoons, where a substantial pergola creates a sensational north-facing alfresco. A superb kitchen features ample timber cabinetry and granite bench space, stainless appliances, dishwasher and a 900mm Delonghi oven, gas top, and rangehood. The home's centrepiece, a glistening

**Price** : \$ 950,000  
**Land Size** : 785 sqm  
**View** : <https://www.ypa.com.au/7464252>



**Jeremy Pate**  
0428 085 280

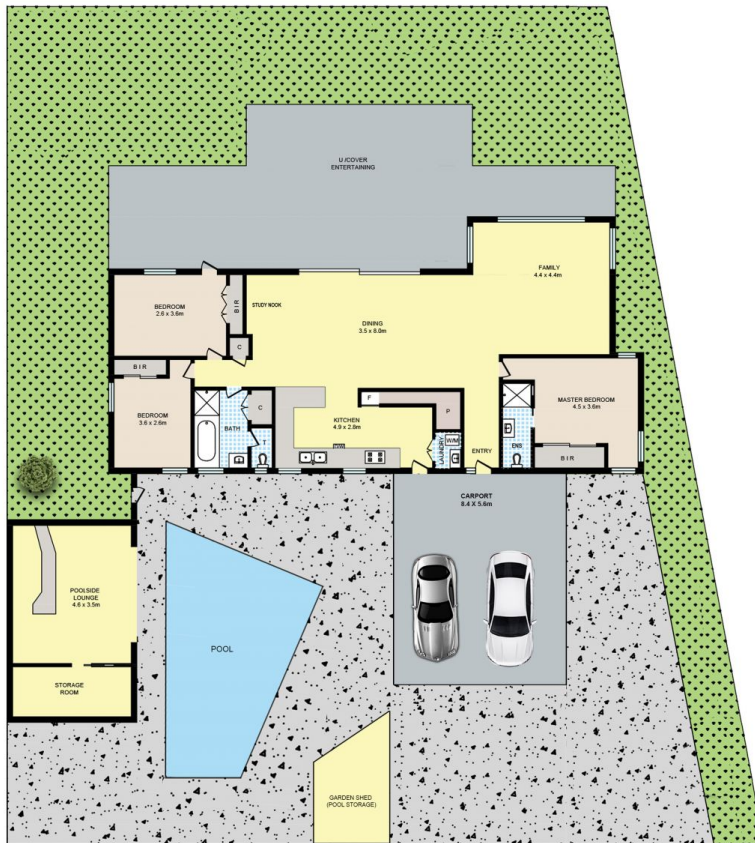

#### 44 KOALA CRESCENT, WESTMEADOWS

Disclaimer: Floor plan is for marketing purposes and is to be used as a guide only. Measurements are approximate and for illustrative purposes. Interested parties should make and rely on their own enquiries or refer to contract drawings for more accurate information.