

27 Sandra Street Melton VIC

5 🏠 4 🚗 6 🚗

Superbly situated on a huge 964m² (approx.) parcel of land, this quality built family home is situated in the heart of Melton's Residential Growth Zone. Located close to all major amenities and showcasing sub-division/development opportunities (STCA), it is easy to see why this area is in such high demand for investors and owner occupiers alike. Comprising of five large bedrooms, master bedroom featuring walk in robe and full enquire, whilst the remaining three bedrooms contain built in robes and are serviced by a fully renovated bathroom.

The formal lounge hosts enough space for the whole family, moving through to the additional open plan living/dining area that is overseen by the stunning vinyl wrapped kitchen that features: ample storage and bench space, dishwasher, 900mm freestanding cooker and built-in steam oven.

Moving towards the rear of the home, the large living zone

Price : \$ 643,000
Land Size : 964 sqm
View : <https://www.ypa.com.au/7400491>



Shane Spiteri
0488 980 115



Mark Edwards
0422 017 068

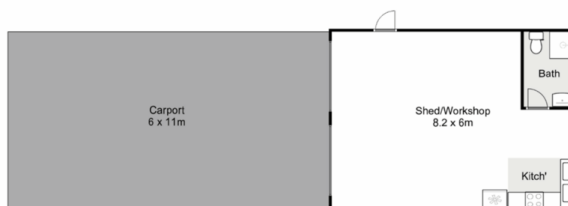

27 Sandra Street, Melton

YPA

Whilst every attempt has been made to ensure the accuracy of the floor plan contained here, measurements of doors, windows, rooms and any other items are approximate and no responsibility is taken for any error, omission, or mis-statement. This plan is for illustrative purposes only and should be used as such by any prospective purchaser. The services, systems and appliances shown have not been tested and no guarantee as to their operability or efficiency can be given.

