



3/7 Avoca Crescent Pascoe Vale VIC

2 1 2

Situated at the end of a quiet tree lined cul-de-sac, this standalone two bedroom villa is ready move straight with all the work done. Located within walking distance to Pascoe Vale train station and Gaffney Street shops, moments to Merri Creek walking and bike trails, easy access to Citylink and zoned to Strathmore Secondary College the location is simply second to none.

Upon entry you are greeted by soaring 9ft ceilings, trimmed with exceptional feature architraves, cornicing and polished hardwood floorboards that flow throughout the living and kitchen areas.

Comprising of two large bedrooms with new carpets and built in wardrobes, a bright renovated bathroom with direct access into the master bedroom. The heart of the home wraps around the beautifully renovated kitchen featuring: ample storage/benchspace, stainless steel appliances, dishwasher and pleasing views over the stylish living and

Price : \$ 651,000

View : <https://www.ypa.com.au/7400407>



Mark Edwards
0422 017 068

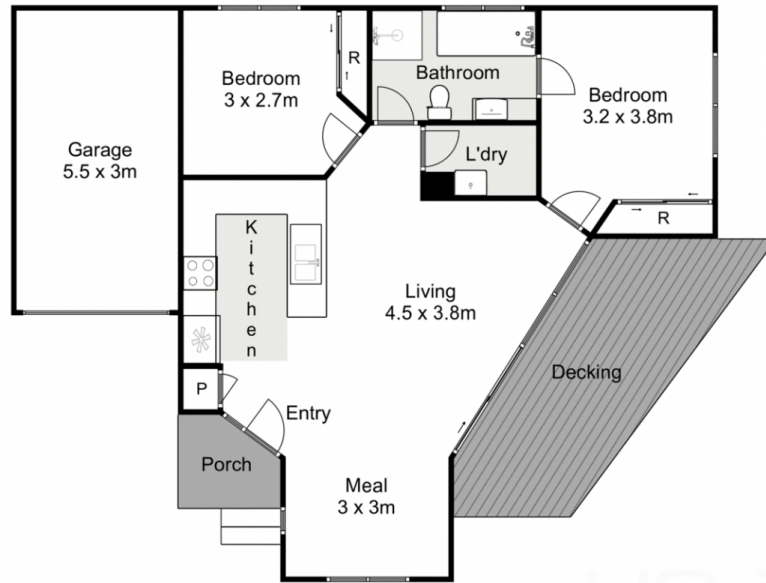

3/7 Avoca Crescent, Pascoe Vale

Whilst every attempt has been made to ensure the accuracy of the floor plan contained here, measurements of doors, windows, rooms and any other items are approximate and no responsibility is taken for any error, omission, or mis-statement. This plan is for illustrative purposes only and should be used as such by any prospective purchaser. The services, systems and appliances shown have not been tested and no guarantee as to their operability or efficiency can be given.

