



3 Light Close Darley VIC

3 2 4

Situated on a huge 814m² (approx.) allotment, this beautifully designed home has all the incredible factors you've been searching for with immaculately landscaped gardens sure to impress any buyer, the substantial proportions of this home make for an extraordinary family lifestyle, located in Darley's most distinguished address with only a short distance to schooling, public transport, freeway access and all amenities, this home is one certainly not to be missed.

Entering this beautiful residence, you are welcomed by a large and light filled formal lounge or theatre room sitting adjacent to the delightful master bedroom, offering a walk-in robe and a stunning ensuite featuring an oversize shower and double vanity. The two remaining bedrooms situated at the back of the home are generously sized while featuring built in robes and are serviced by a lovely bright

Price : \$ 745,000
Land Size : 814 sqm
View : <https://www.ypa.com.au/7400396>



Shane Spiteri
0488 980 115

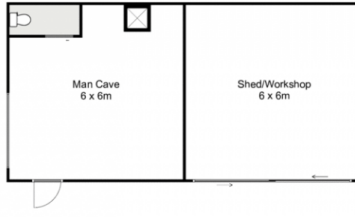

3 Light Close, Darley

Whilst every attempt has been made to ensure the accuracy of the floor plan contained here, measurements of doors, windows, rooms and any other items are approximate and no responsibility is taken for any error, omission, or mis-statement. This plan is for illustrative purposes only and should be used as such by any prospective purchaser. The services, systems and appliances shown have not been tested and no guarantee as to their operability or efficiency can be given.

