



142 Dalray Crescent Kurunjang VIC

3 2 2

Displaying an impressive blend of captivating modern features and contemporary style, this home makes for a sensational low maintenance family domain. Located in the heart of Kurunjang within short distance to the local zoned primary school, shopping complexes, sporting grounds, public transport and adjacent from a huge reserve making this the ideal family location.

From the moment you walk in you will begin to picture your life in this gorgeous family home. The master bedroom offers a walk-in robe and an ensuite with mirrored sliding doors. The remaining bedrooms are all carpeted and generously sized with built in robes and a beautiful, bright central bathroom. This fully equipped family domain also offers a large study or front formal living area.

The kitchen is open and inviting consisting of stainless-steel appliances including gas cooktop, oven and

Price : \$ 500,000
Land Size : 596 sqm
View : <https://www.ypa.com.au/7400008>



Shane Spiteri
0488 980 115



Maddison Paans
0433 239 783

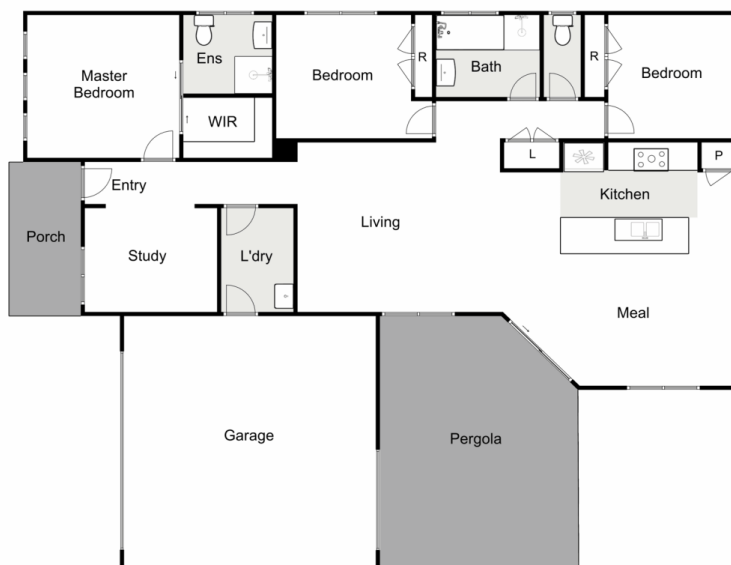

142 Dalray Crescent, Kurunjang

Ypa

Whilst every attempt has been made to ensure the accuracy of the floor plan contained here, measurements of doors, windows, rooms and any other items are approximate and no responsibility is taken for any error, omission, or mis-statement. This plan is for illustrative purposes only and should be used as such by any prospective purchaser. The services, systems and appliances shown have not been tested and no guarantee as to their operability or efficiency can be given.

