



## 35 O'Neills Road MELTON VIC

4 2 2

Located in central Melton and within walking distance to High Street, Woodgrove Shopping Centre, Melton Waves, schools and public transport is this beautiful fully functional home ready for you to move straight in!

Boasting 4 spacious bedrooms, with the master bedroom featuring a walk-in robe and ensuite. The property also boasts 2 living areas and open plan living to suit every new occupier.

Moving outside, you have an undercover entertaining area to dine outdoors in every season, with space for the whole family. Side access for storage of your trailer/caravan and enough space for the kids to run and play.

Special features include: double lock up garage, evaporative cooling, ducted heating, roller shutter blinds to front of the property, large garden shed & the list continues

**Land Size** : 578 sqm

**View** : <https://www.ypa.com.au/7399517>



**Shane Spiteri**  
0488 980 115

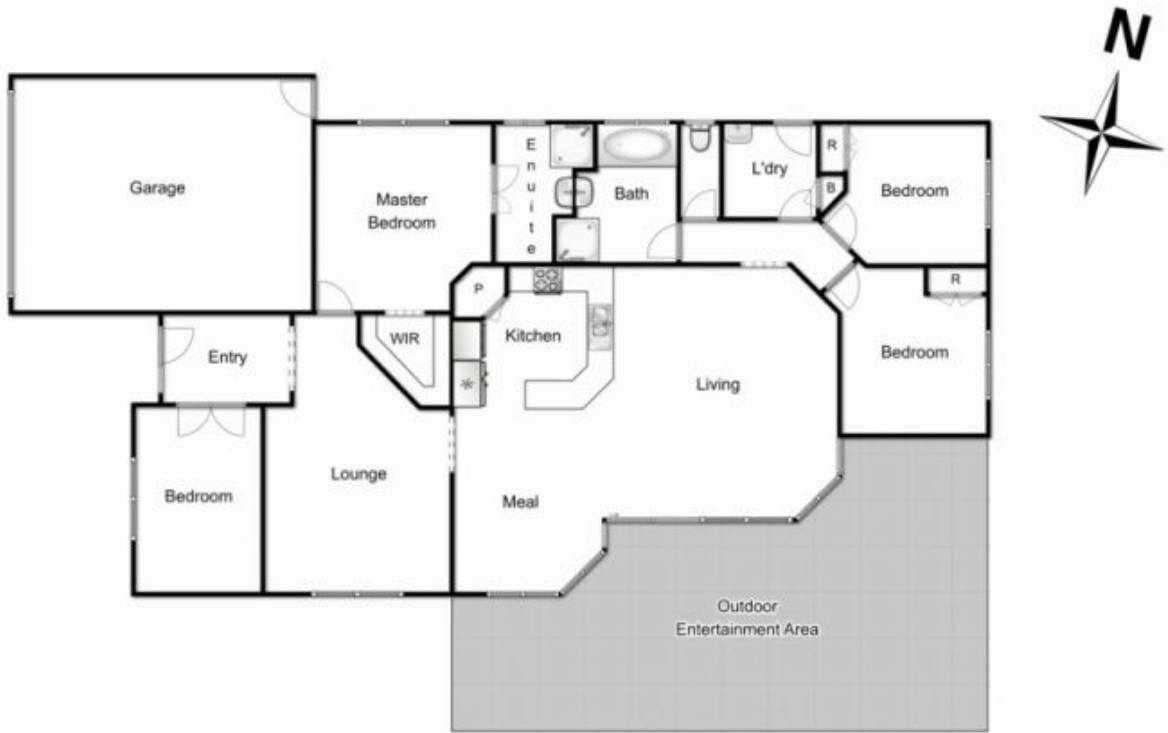

## 35 O'Neills Road, Melton

YPA

Whilst every attempt has been made to ensure the accuracy of the floor plan contained here, measurements of doors, windows, rooms and any other items are approximate and no responsibility is taken for any error, omission, or mis-statement. This plan is for illustrative purposes only and should be used as such by any prospective purchaser. The services, systems and appliances shown have not been tested and no guarantee as to their operability or efficiency can be given.

