



**21 Turpentine Road BROOKFIELD VIC**

4  2  2 

Investors take note.

Behind the classy modern facade, this light filled home will surprise at every turn.

Providing four great size bedrooms (master with full ensuite & WIR), and well-designed kitchen with quality stainless steel appliances that overlooks the family/ meals area. Set on a great size allotment with a long list of inclusions from gas ducted heating, cooling, double garage with internal and drive through access..

Currently tenanted at until June 2018 at \$320 per week, this will make the perfect addition to your investment folio.

Inspections are truly our pleasure, call today to arrange your viewing!

**Land Size** : 439 sqm

**View** : <https://www.ypa.com.au/7399344>



**Shane Spiteri**  
0488 980 115

21 Turpentine rd, Brookfield

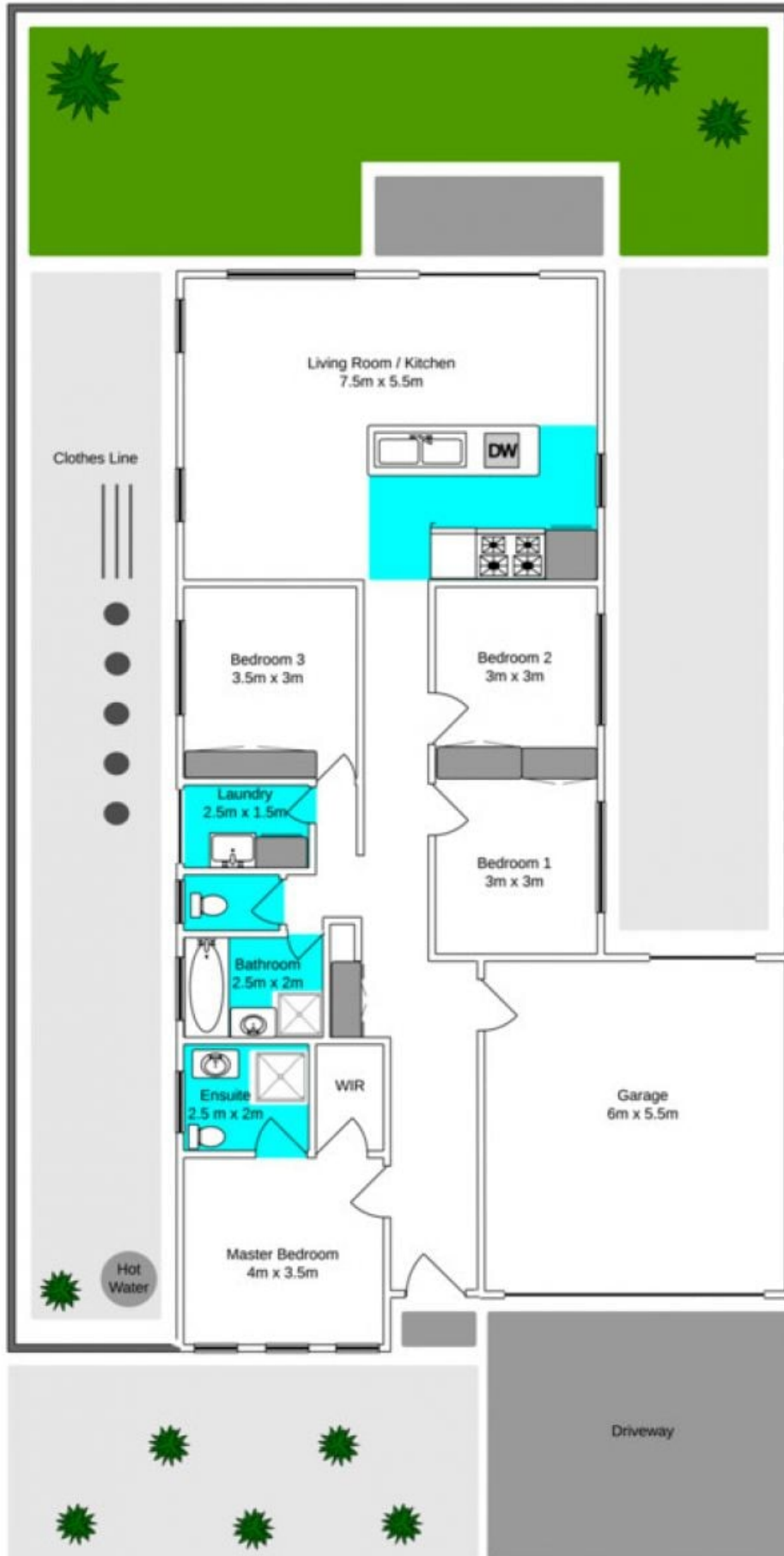

Whilst every precaution has been taken to establish the accuracy of the above information, Prospective buyers are advised to make their own enquiries.

