



46 Halletts Way BACCHUS MARSH VIC

3  1  2 

The perfect way to create a grand, inviting entrance to a home is with a beautifully landscaped setting. This dwelling combines the beauty and exquisiteness of a lovingly cultivated garden that begins as soon as you enter.

Land Size : 795 sqm

View : <https://www.ypa.com.au/7399317>

This charming property has cathedral ceilings and a warm and unique layout felt immediately upon entry and allows for a perfect balance of internal and external space. This impressive example of family living is extremely well designed with both informal and formal living areas. Natural light and inviting spaces make living a joy in all seasons and your modern kitchen is located in the heart of the home and features high quality stainless steel appliances, along with ample bench space and storage.

Internal features include a large master bedroom with direct access to your bright and modern bathroom including bath.

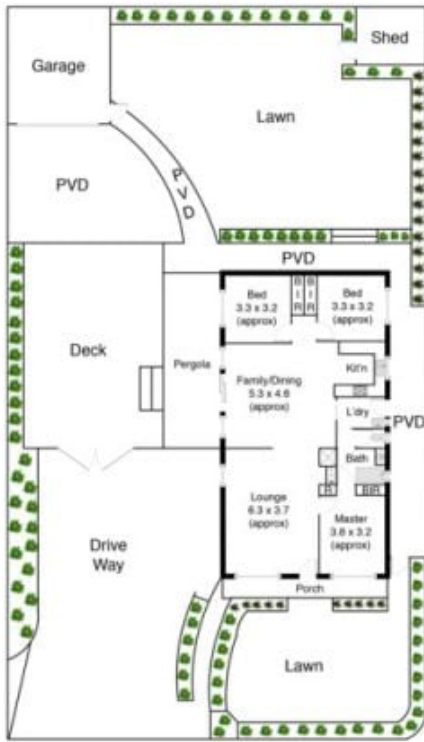

6 Halletts Way Bacchus Marsh

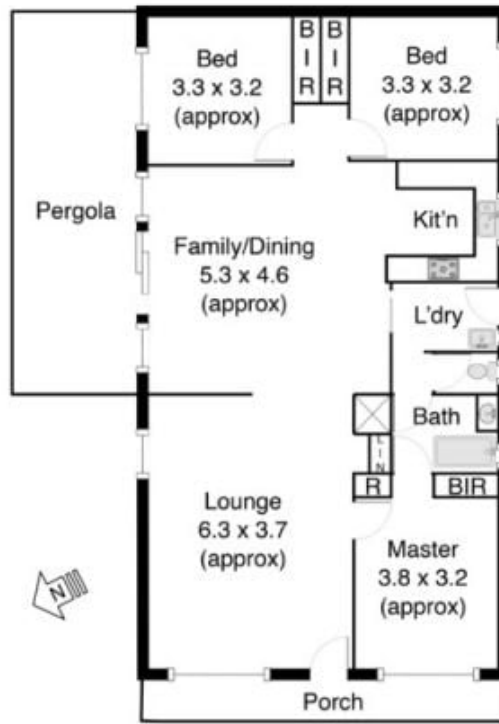

All Dimensions are approximate

