



59 First Avenue MELTON SOUTH VIC

4 1 2

Looking for an investment property that has potential to obtain huge future financial gains? This fantastic home is perfectly positioned on a opportunistic 590m2 (approx.) block, zoned in the highly sought after Residential Growth Zone within 370 meters of the Melton South train station, featuring approved plans and permits for a modern second home with access via Hazel Street, it has so much character and endless potential you cant afford to miss out. Located within the closest proximity to not only the highly important train station, but also walking distance to medical centres, all levels of schooling, Melton South shopping district, restaurants and cafes and multiple recreational areas, you would be hard pushed to find a more appealing investment location. Comprising of four bedrooms, large lounge room, meals area, spacious and enticing kitchen, this exclusive renovated home is complemented by its attention to detail with polished floorboards throughout,

Land Size : 590 sqm

View : <https://www.ypa.com.au/7399302>

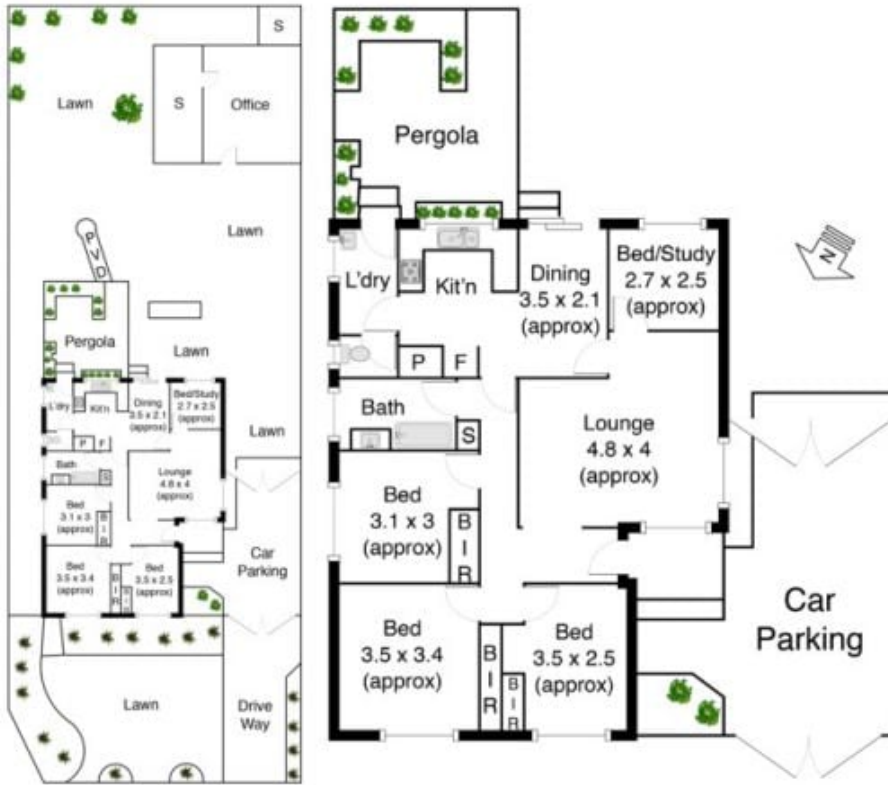

59 First Avenue Melton South

All Dimensions are approximate

Ypa