



63 Exford Road MELTON SOUTH VIC

3  1  2 

Situated in the Melton South, this home has everything to offer! Starting with a large allotment of approximately 531m², the home has ideal space for the growing family. Also offered, are three generously sized bedrooms all with built in robes, renovated central bathroom with and a good sized meals area with plenty of natural light. Kitchen has also been renovated with a stainless free standing cooker; dishwasher and plenty of cupboards and bench space, other features include roller shutters, ducted heating and two split systems. Great size garage or Man Cave and plenty of backyard truly helps tick all the boxes! Within close walking proximity, schools, shops and train station also nearby. Don't Delay, Enquire today!

Land Size : 531 sqm

View : <https://www.ypa.com.au/7399299>



Vickie Ramon
0403 194 621

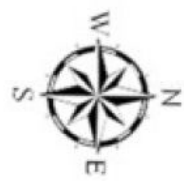
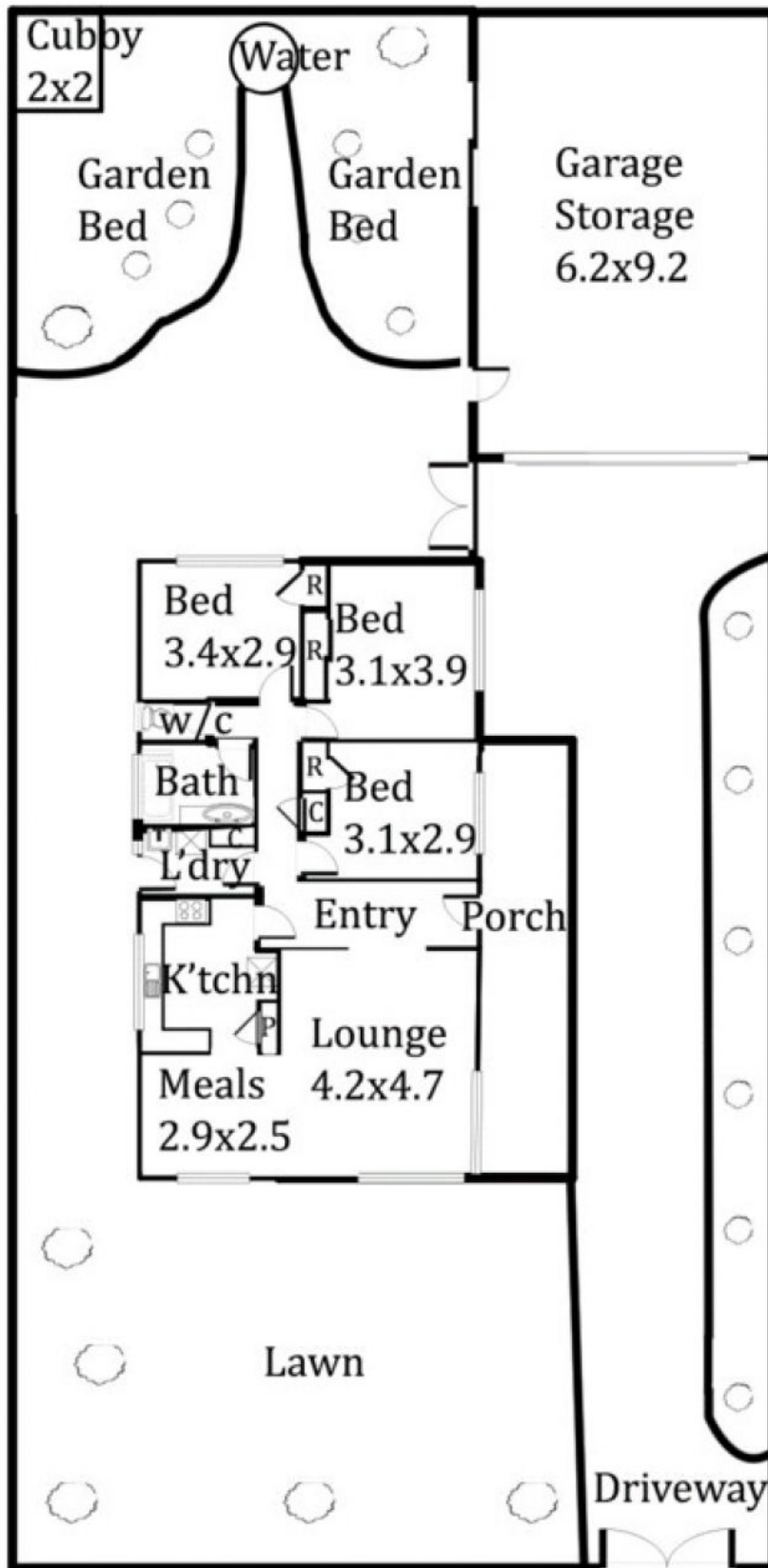

63 Exford Rd Melton Sth

Floor plan measurements are approximate and are for illustrative purposes only. While we do not doubt the floor plan's accuracy we make no guarantee, warranty or representation as to the accuracy and completeness of the floor plan. You or your advisors should conduct a careful investigation of the property to determine your satisfaction as to the suitability for your space requirements.