



## 34 Castletown Boulevard MELTON SOUTH VIC

4 2 2

Well located in Waterford Estates is this spacious four bedroom home. The main bedroom features ensuite and walk in robe, all other bedrooms with built in robes. Two separate living areas located at either end of the house, and a large modern and functional kitchen with stone benches, complete with stainless steel appliances, ducted heating and modern floor plan, all complement this property. Externally there is a double car garage with remote roller door with internal access situated on a 504m<sup>2</sup> (approx.) allotment. All this Located in one of Meltons most sort after estate, this one could be all you are looking for. Call now for an inspection.

**Land Size** : 507 sqm  
**View** : <https://www.ypa.com.au/7399287>



**Vickie Ramon**  
0403 194 621

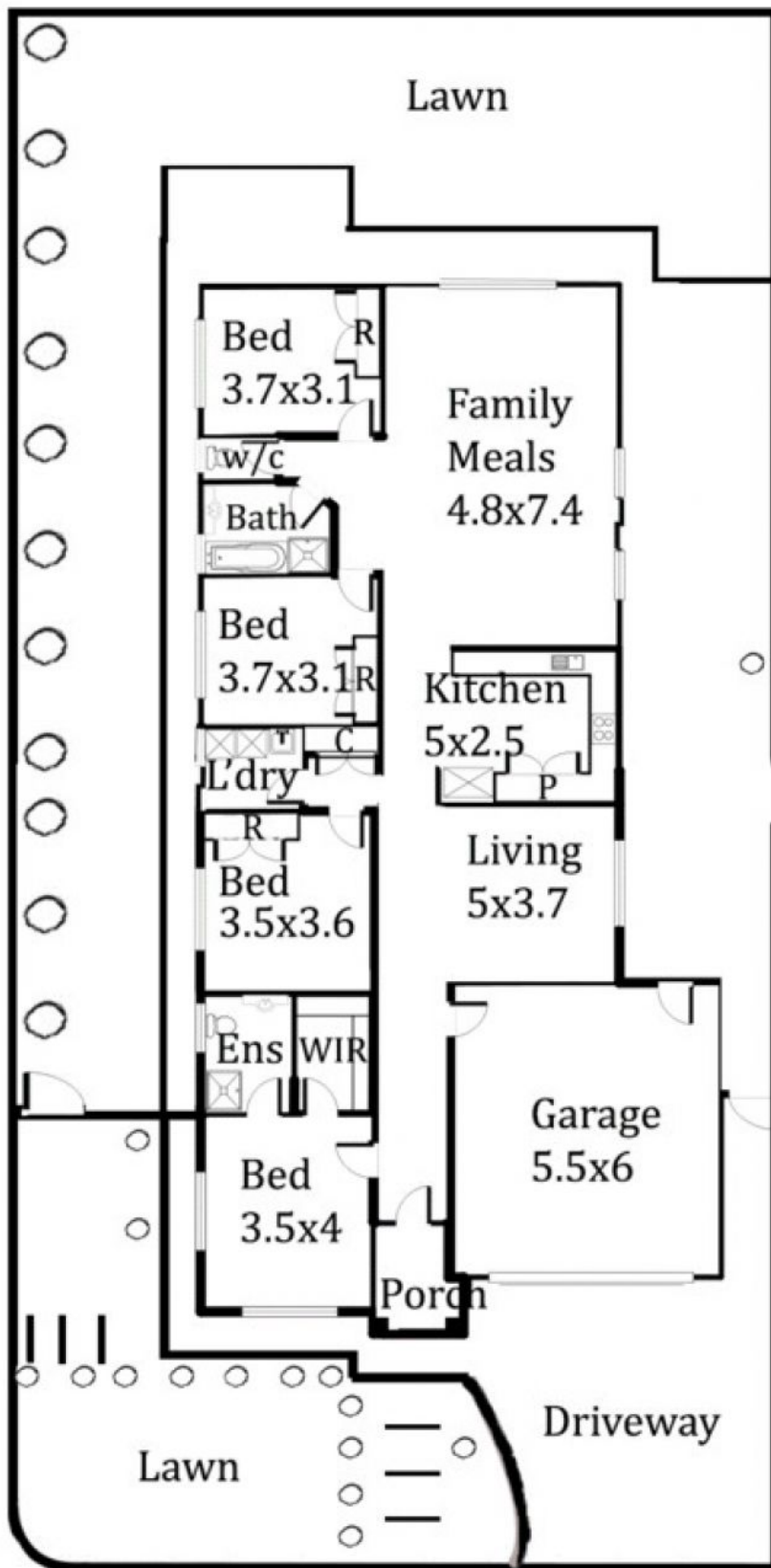

## 34 Castletown Bld Melton South

Floor plan measurements are approximate and are for illustrative purposes only. While we do not doubt the floor plan's accuracy we make no guarantee, warranty or representation as to the accuracy and completeness of the floor plan. You or your advisors should conduct a careful investigation of the property to determine your satisfaction as to the suitability for your space requirements.