

# Ypa



## 5 Densley Court DARLEY VIC

3 2 2

Positioned in the beautiful Elms Estate on a 1231m<sup>2</sup> (approx), This home impresses at first sight, blending sleek renovations with modern comfort, which proudly defines this desirable and captivating family home. Displaying excellent street appeal, brimming with charm. One step inside and the pleasure continues with an inviting and flexible floor plan, boasting 3 bedrooms, main master bedroom with a stylish ensuite and walk in robe, stunning large living area, double car storage with huge side access! The hub of the has been completely renovated with style, kitchen with high quality appliances and complementary stone bench tops adjoining the dining. Sliding doors open out to the large covered alfresco area providing a personal vista to the established gardens. This delightful home also enjoys the comfort of ducted heating & evaporative cooling, fully renovated central bathroom and laundry plus much much more. Call before its too late!

**Land Size** : 1231 sqm

**View** : <https://www.ypa.com.au/7399275>



**Shane Spiteri**  
0488 980 115

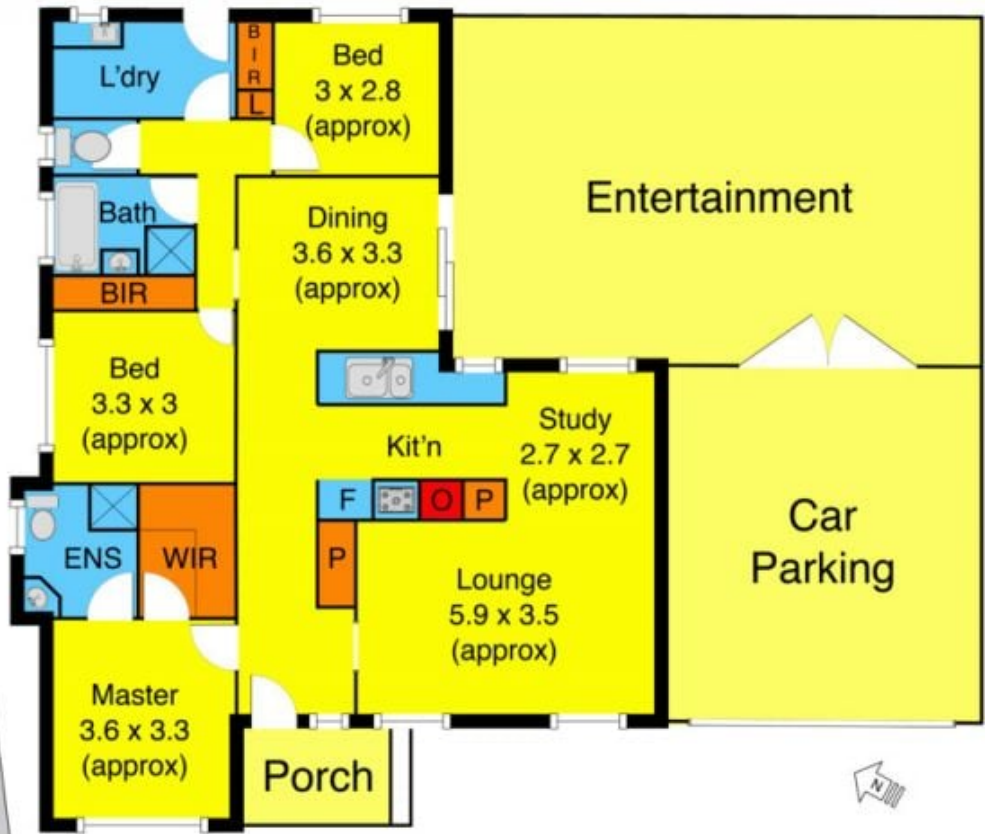

Densley Ct