

39 Archer Drive KURUNJANG VIC

4  2  3 

Displaying an impressive blend of captivating modern features and contemporary style, the generous proportions of this Burbank display quality home make for a sensational family domain located in the most sought after of locations. Directly facing the recreational reserve, this home offers glamorous ambience throughout in combination with the finest & latest upgrades makes this a fantastic value for your money. Comprising of 4 bedrooms, 2 bathrooms plus guest powder room, master bedroom with walk in robe, full en-suite & private views, an impressive amount of living space ensure room for the whole family, including large study upon entrance, generous sized upstairs family living/retreat area, spacious front formal lounge, elegant central living area, dining area, the beautiful kitchen not only appeals aesthetically but boasts a long list of upgrades including, huge walk in pantry and high quality appliances. The light-filled free flowing floor plan including enormous

Land Size : 761 sqm

View : <https://www.ypa.com.au/7399252>

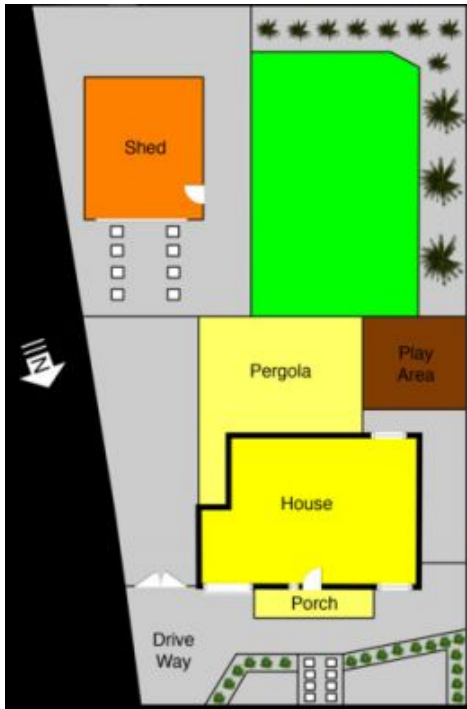

Ground Floor

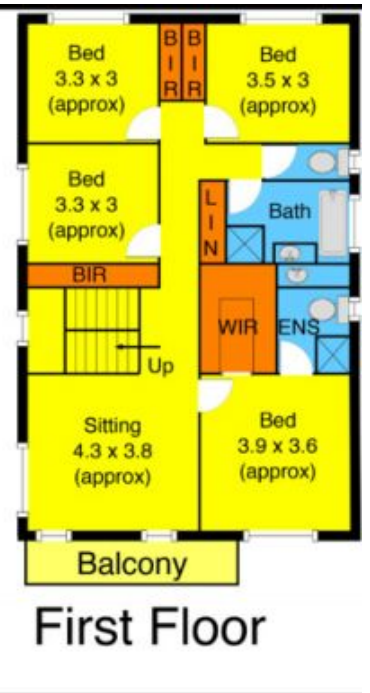

First Floor