



**20 Chanticleer Avenue MELTON WEST VIC**

4 2 2

Perfectly positioned in the amazing Arnolds Creek Estate this perfect family home is finished to the highest quality & standards. Boasting with: Four generous sized bedrooms, main bedroom with full ensuite including his/hers walk-in robe, formal living room, large theatre room and large open plan living /dining space which opens to an alfresco entertaining area outside. This home is complimented by a gourmet kitchen with stainless steel appliances, central main bathroom and laundry. Added extras include remote garage with internal access, drive through access, 9ft ceilings, landscaped gardens, security cameras, alarm system, speaker system, solar panels, 2000L water, garden shed and gas ducted heating and evaporative cooling all set on a 548m2 allotment (approx.) Built by our local award winning builders Exclusive Homes, winners of the Melton Shire Council Best Trade and Construction Business six years in a row. Dont wait call today to

**Land Size** : 548 sqm  
**View** : <https://www.ypa.com.au/7399221>



**Shane Spiteri**  
**0488 980 115**

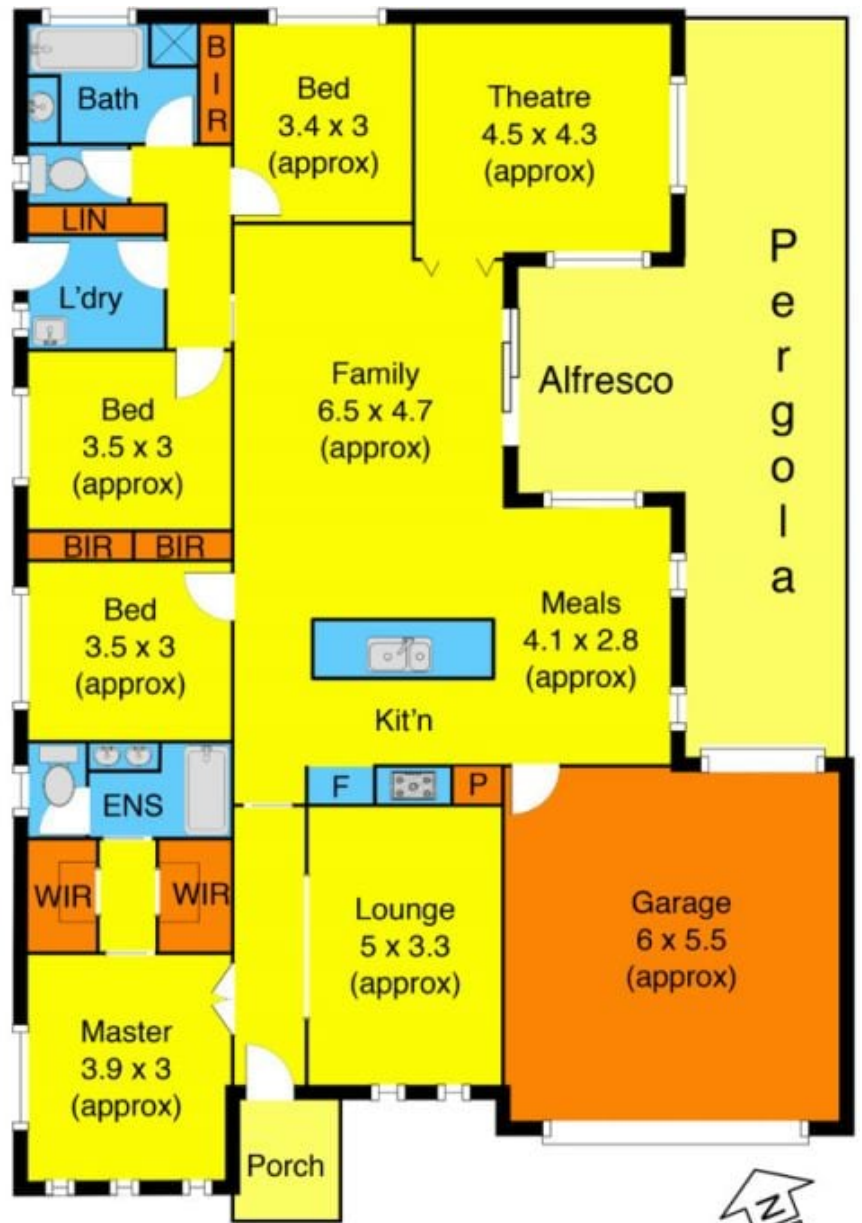
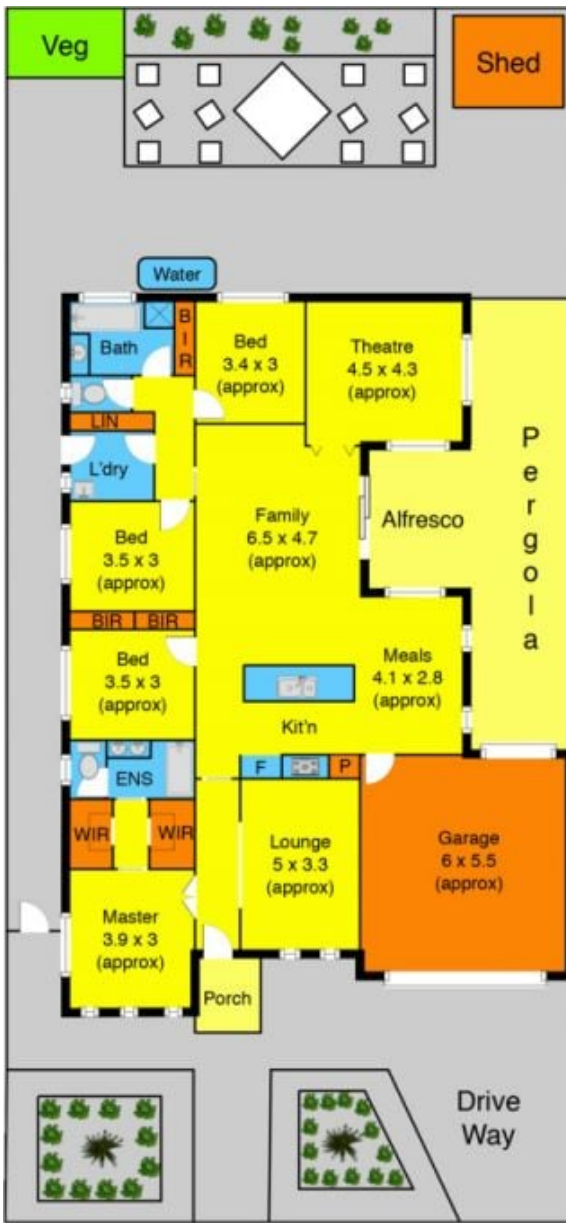

Chanticleer Av