



## 69 Dalray Crescent KURUNJANG VIC

4  2  2 

Upon entering this beautiful home, you will be instantly impressed by its bright and spacious feel.

Comprising of three family sized living zones, four bedrooms including huge master bedroom WIR and ensuite, central bathroom, large light-filled kitchen with quality appliances overlooking open plan living and dining, leading out to a large deck and pergola where you can entertain family and friends with ease all-year-round.

Further complimented by a double remote lock up garage, drive through access, ducted heating, air conditioning, huge 799m2 block (approx), side access, beautifully landscaped gardens to the front and rear of the home, and so much more.

Positioned amongst local schools, public transport and

**Land Size** : 799 sqm

**View** : <https://www.ypa.com.au/7399194>



**Shane Spiteri**  
0488 980 115

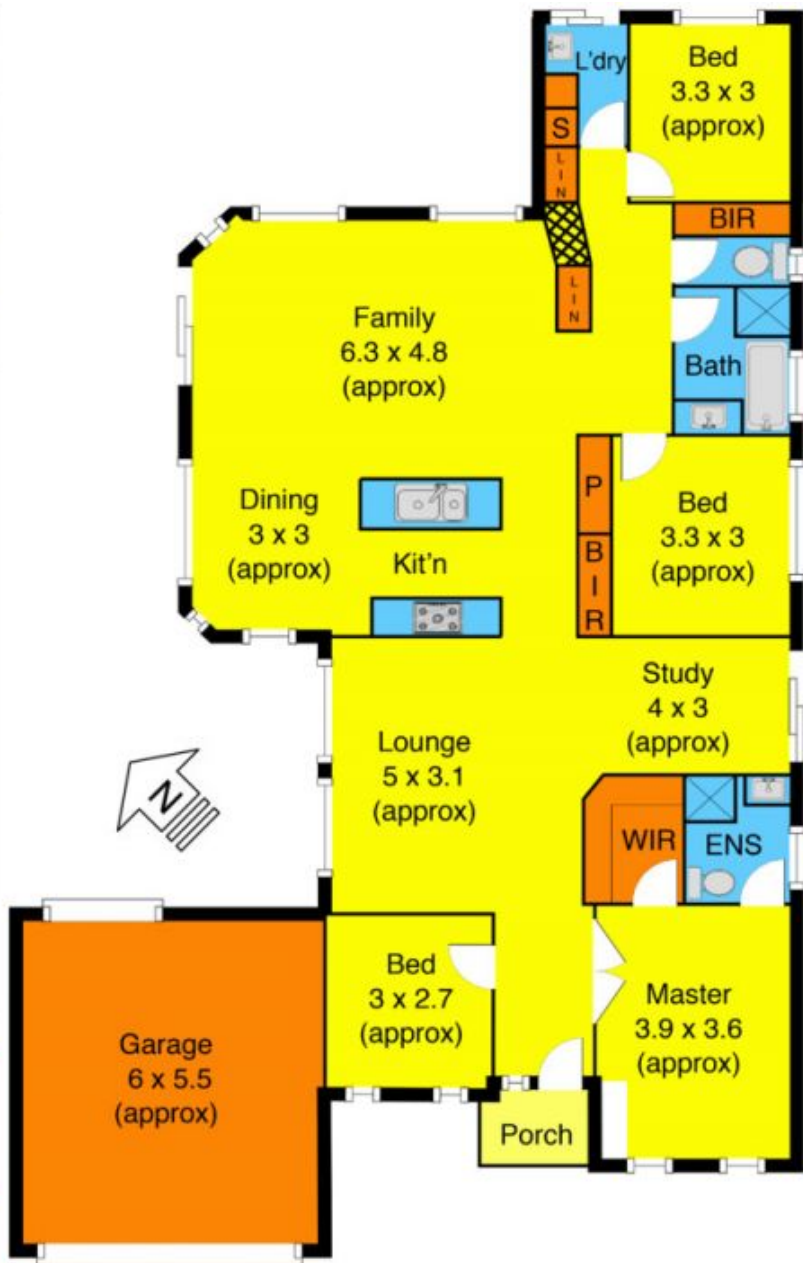

Dalray Crescent