

ypa



11 Crepe Myrtle Close MELTON WEST VIC

4  2  2 

This exciting piece of Melton real estate, positioned in the highly sought after Arnold's Creek Estate, boasts inclusions and finishes of the highest quality and offers the lucky purchaser extras and upgrades that simply must be seen to be believed. This wonderful home comprises of 4 bedrooms, 2 bathrooms, open modern kitchen with large walk in pantry, huge dining area, separate lounge area with plantation feature cut out to enormous rumpus/theatre room, alfresco area, double garage plus internal access! Just move in and relax as everything is completed to the highest quality. List of upgrades that you simply wont find anywhere else; evaporative cooling & ducted heating, stone bench tops to kitchen, down lights throughout, deluxe carpet & tiling, 600mm wall oven with 900mm cook top and stainless steel canopy range hood, large gainden shed with private BBQ area for all your entertaining needs, upgraded internal tiling to wet areas, Extensive concreting to rear and

Land Size : 610 sqm

View : <https://www.ypa.com.au/7399193>

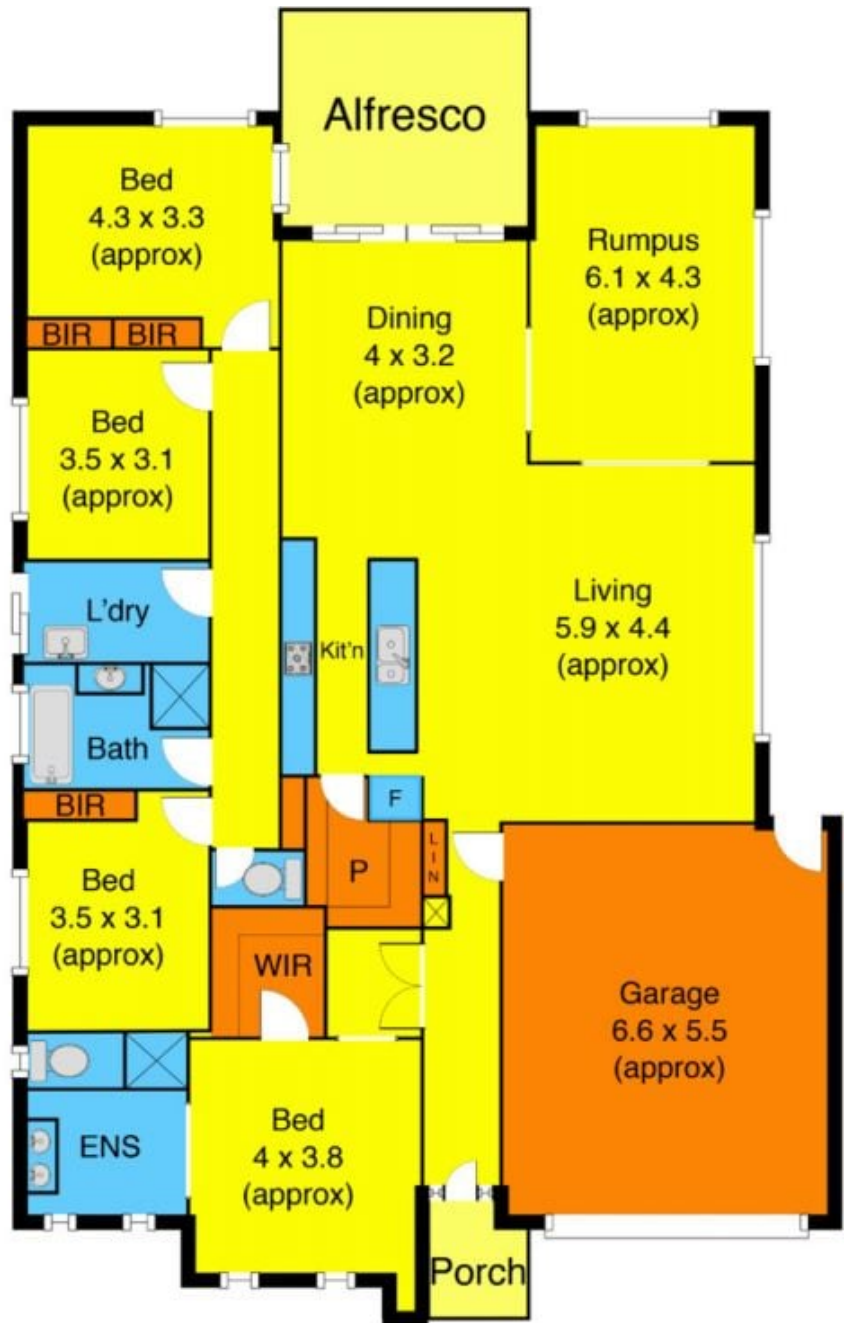
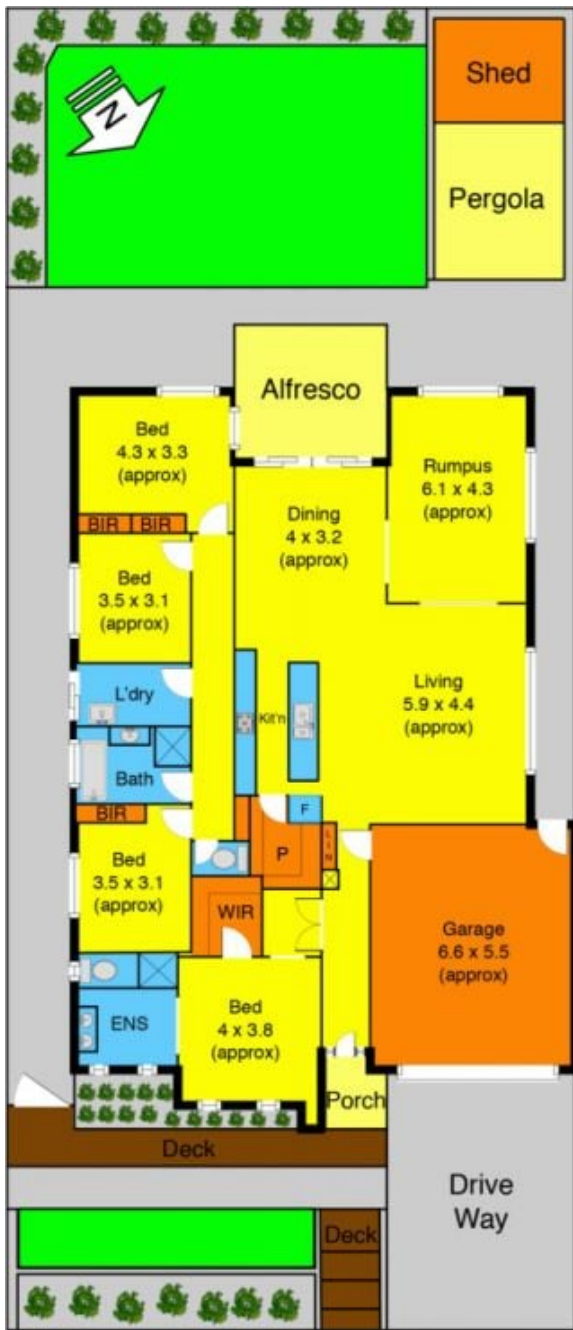

Crepe Myrtle