



33 Castletown Boulevard MELTON SOUTH VIC

4  **2**  **2** 

Displaying an impressive blend of captivating modern features and contemporary style, the generous proportions of this Simonds built home make for a sensational family domain located in the new Waterford Estate in Melton South. This home offers glamorous ambience throughout in combination with the finest & latest upgrades make this a fantastic value for your money. Comprising of 4 bedrooms, 2 bathrooms, master bedroom with walk in robe, full en-suite, impressive theatre room, custom designed study with feature cut out allowing the flow of this open home continue throughout, an substantial amount of living space ensures room for the whole family, the beautiful hostess kitchen not only appeals aesthetically but boasts a long list of upgrades including stone bench tops, huge pantry and high quality appliances. The light-filled free flowing floor plan opens out onto the outdoor area, fully concreted with ready to go gas and electricity outlets to install the outdoor

Land Size : 543 sqm

View : <https://www.ypa.com.au/7399177>

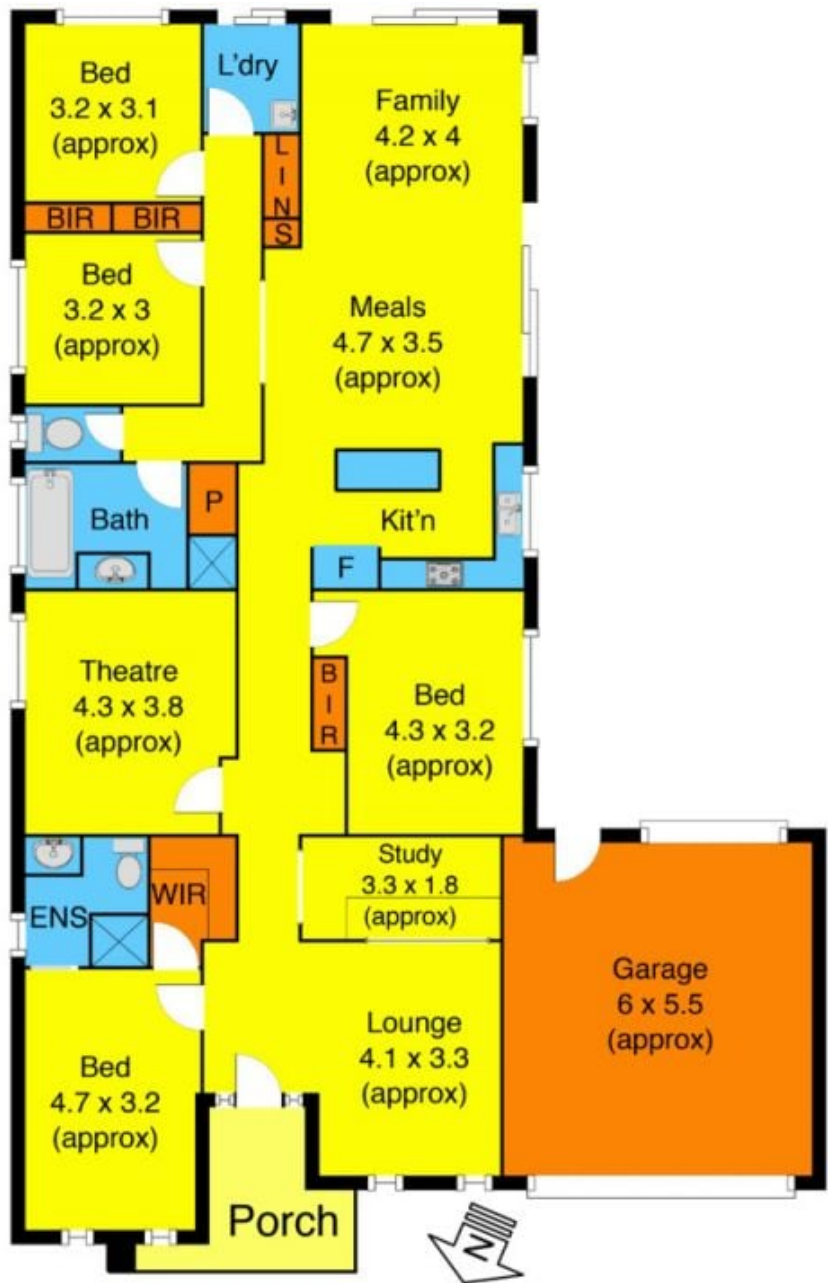

Castletown blvd