



14 Swan Street MELTON VIC

3  1  2 

This immaculately presented home is well maintained and fully renovated to the last detail. Situated in the heart of Melton, comprising of 3 double bedrooms, stunning kitchen with stainless steel appliances and ample storage, great size lounge, renovated central bathroom and more! Boasting: timber floors, heating and cooling and situated on 582m² land (approx.) with prospective sub-division (STCA).

Other features include: alarm system, lock up garage, landscaped surrounds and so much more. Suited to a first home buyer or astute investor or family.

Conveniently positioned near transportation, shops and amenities. Call now to arrange a viewing.

Land Size : 582 sqm

View : <https://www.ypa.com.au/7399156>



Mark Edwards
0422 017 068

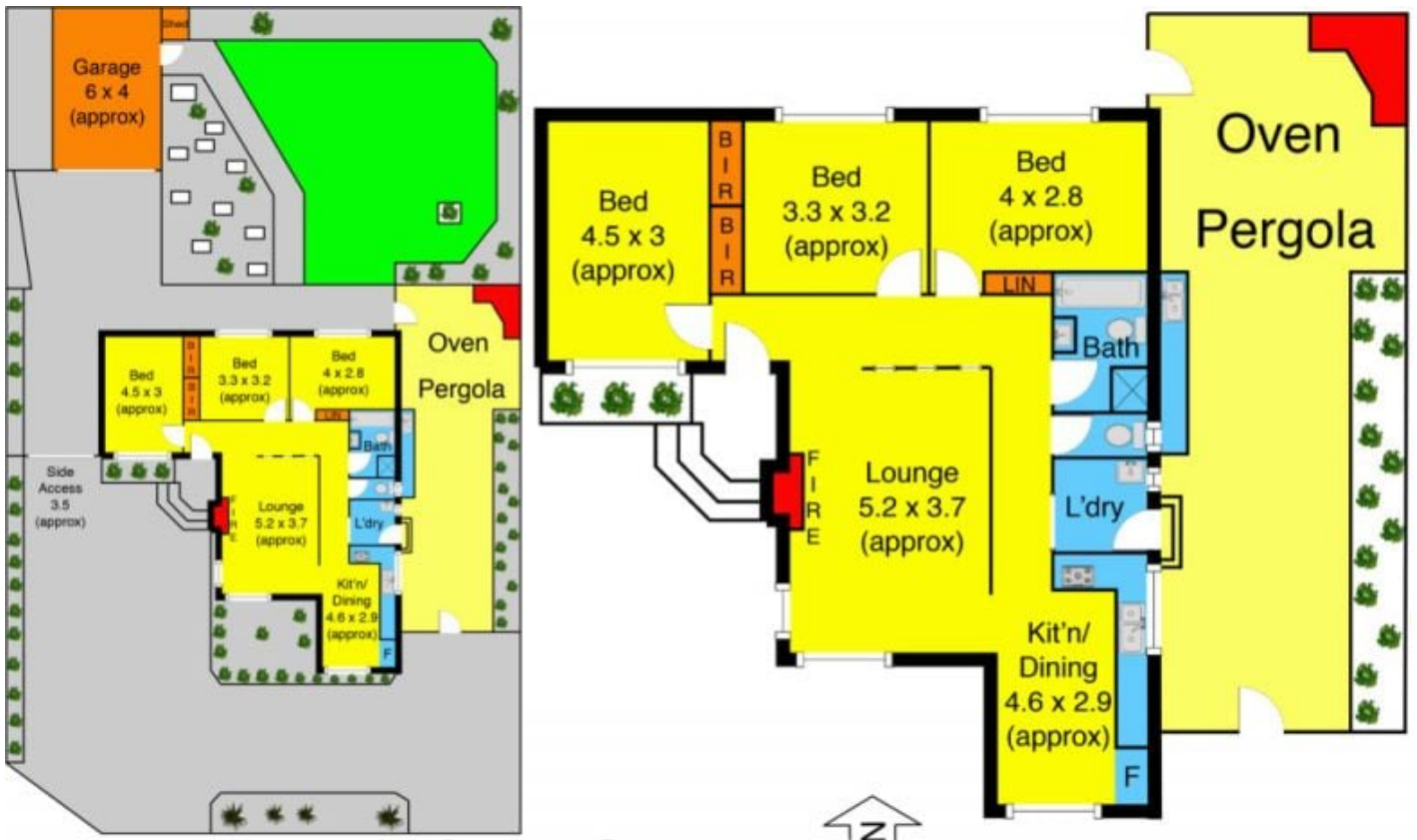

Swan St