

# ypa



**7 Kayla Way KURUNJANG VIC**

**3**  **2**  **2** 

This charming and immaculately presented family style home, set in a quiet street close to local parks and public transport, is sure tick all the boxes for anyone searching the property market.

Set on a large allotment of 573m<sup>2</sup> (approx.) there is definitely room to move. Comprising of three oversized bedrooms with BIRs (master with WIR and ensuite, spacious kitchen with ample storage, bench space and stainless steel appliances overlooking, open plan dining area and large rumpus retreat at the rear of the home overlooking the tidy yard.

Outside awaits all your needs with extensive concreting patio area, low maintenance yard, drive through access and potential side access.

Other inclusions of this fantastic property include: ducted heating, cooling, double lock up garage and so much more. Dont hesitate, book an inspection today.

**Land Size** : 573 sqm

**View** : <https://www.ypa.com.au/7399090>



**Mark Edwards**  
**0422 017 068**

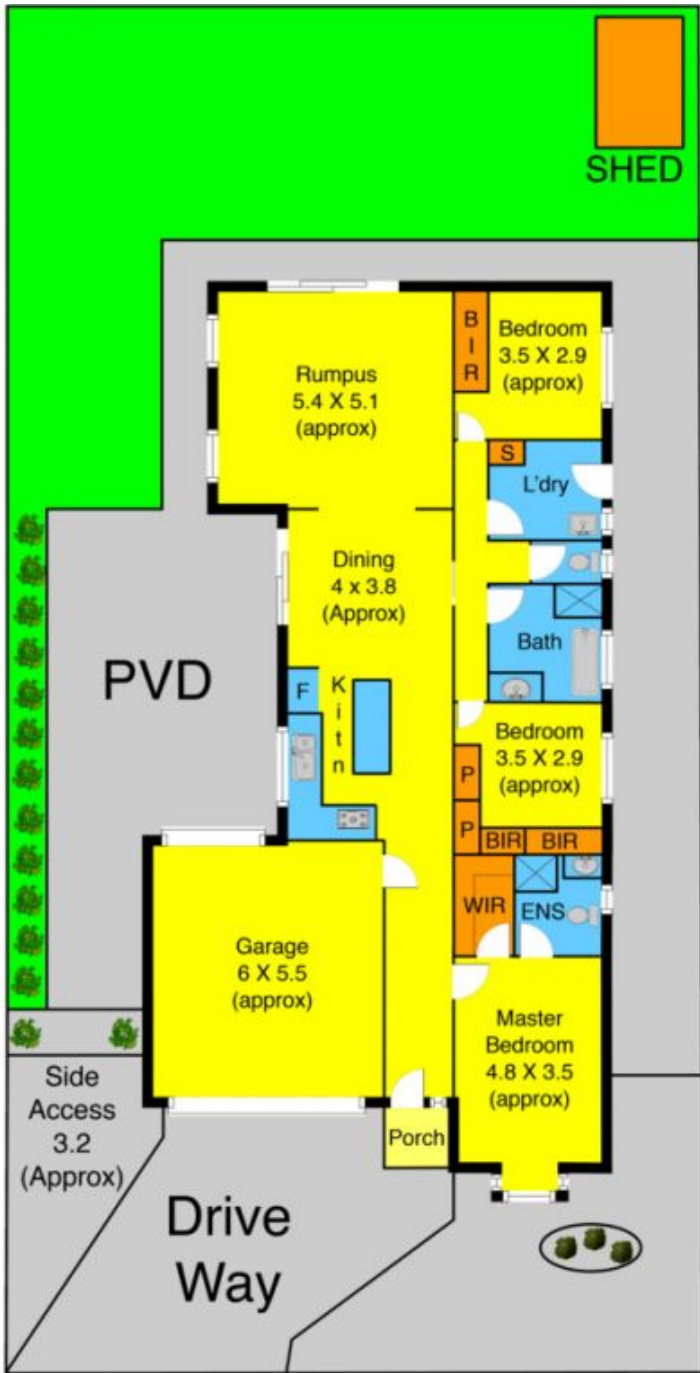

Kayla Way

