



26 Bridgeford Crescent MELTON SOUTH VIC

3 1 2

Located close to Melton Train Station, schools and shopping centre this beautifully maintained well-presented one owner home will not disappoint. Features include well-appointed kitchen, spacious lounge, meals, rumpus and 3 bedrooms, master with walk in robe. Opening the glass double doors from the rumpus, exposes the remainder of the 584m² block, with a secured 2 car remote control carport, the rear access makes room available for off street parking for 4 cars. Other features include gas heating and wall air conditioner, 2 garden sheds (1 powered), fully landscaped and well maintained front and backyard. Call to make a time to view this amazing home.

View : <https://www.ypa.com.au/7399016>

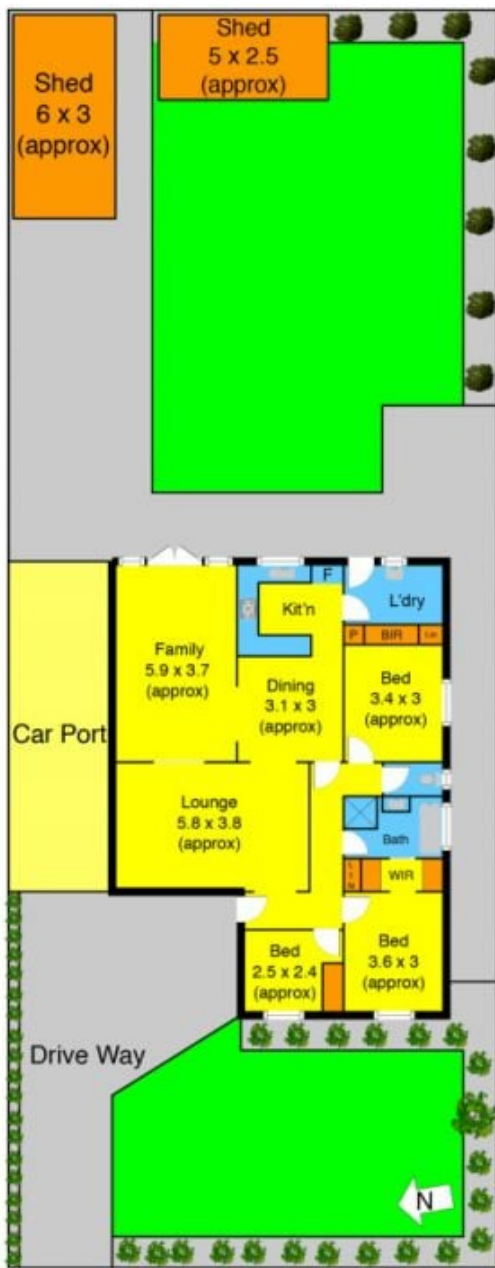

Bridgeford Crescent

