

## 16 Sunderland Way MELTON WEST VIC

3  2  2 

Located in the ever popular Westlakes estate, this lovely and spacious home is set on a huge allotment of 777m<sup>2</sup> (approx).

Boasting: three spacious bedrooms with BIR, master with WIR and ensuite, two living areas, modern kitchen with gas cooking, stainless steel appliances and adjoining meals area.

Other features include evaporative cooling, central heating, double garage with remote control and drive through access, huge outdoor entertaining area surrounded by easily maintained gardens perfect for entertaining all year around.

Currently leased until 8/6/2016 and returning \$1365 per month with perfect tenants, this is the perfect investment! Call today to view this stunning property!

**Building Size** : 3 sqm  
**Land Size** : 774 sqm  
**View** : <https://www.ypa.com.au/7398966>



**Shane Spiteri**  
**0488 980 115**

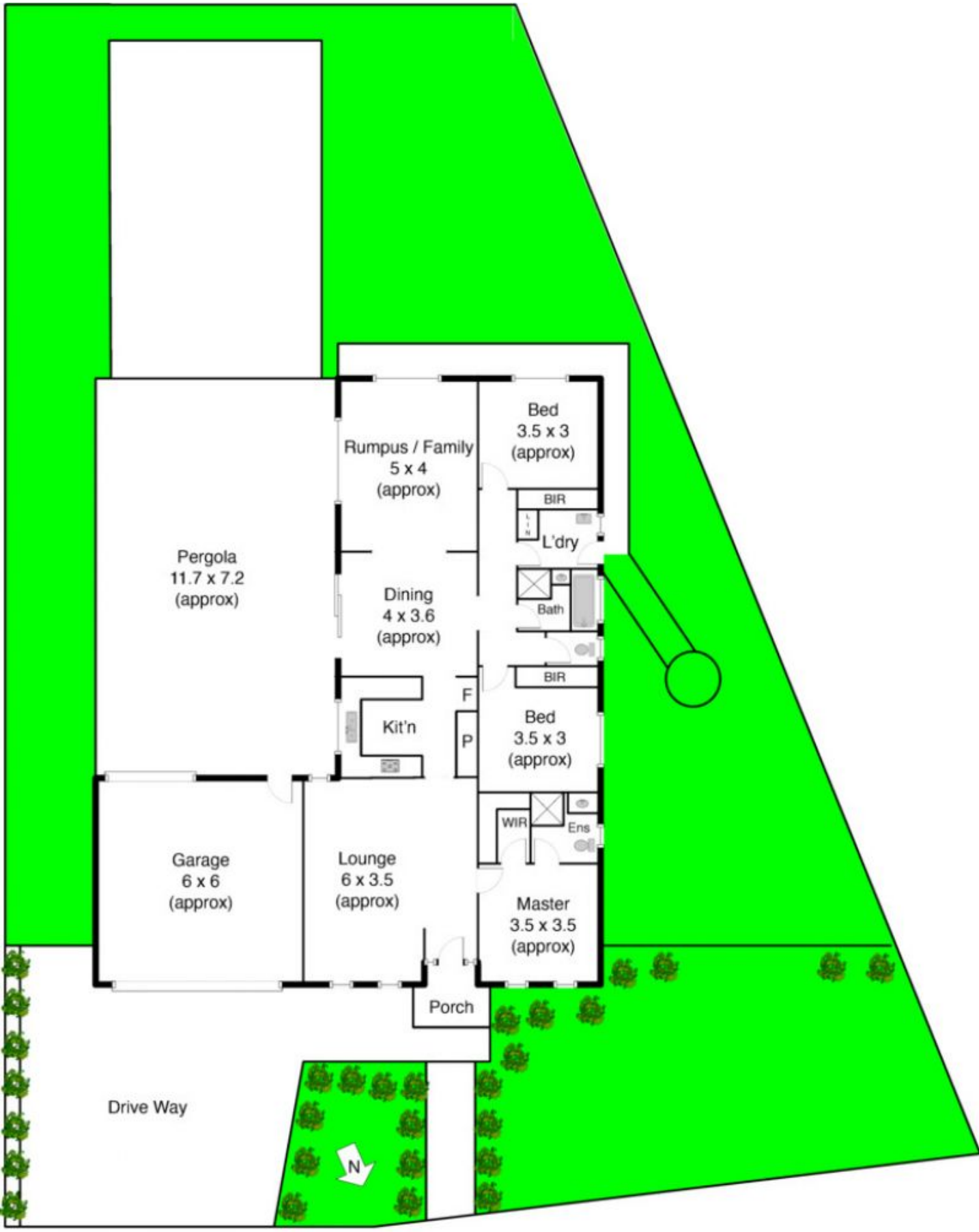

Sunderland Way