



## 31 Alkemade Drive MELTON VIC

This delightful home offers excellent value to the home buyer or investor. Consisting of 3 bedrooms all with built in robes, master with ensuite an open plan kitchen with ample bench space and storage. Adjoining the kitchen is the meals area followed by the spacious lounge. Extras to the property include gas heating and wall air conditioner and much more. Set on an approx.773m2 allotment, plenty of room for the kids to play or potential to subdivide S.T.C.A. Conveniently located within a short walk to, schools, Woodgrove Shopping Centre, public transport and parks. Call today to inspect

3 2

**Building Size** : 2 sqm  
**Land Size** : 773 sqm  
**View** : <https://www.ypa.com.au/7398965>



**Vickie Ramon**  
0403 194 621

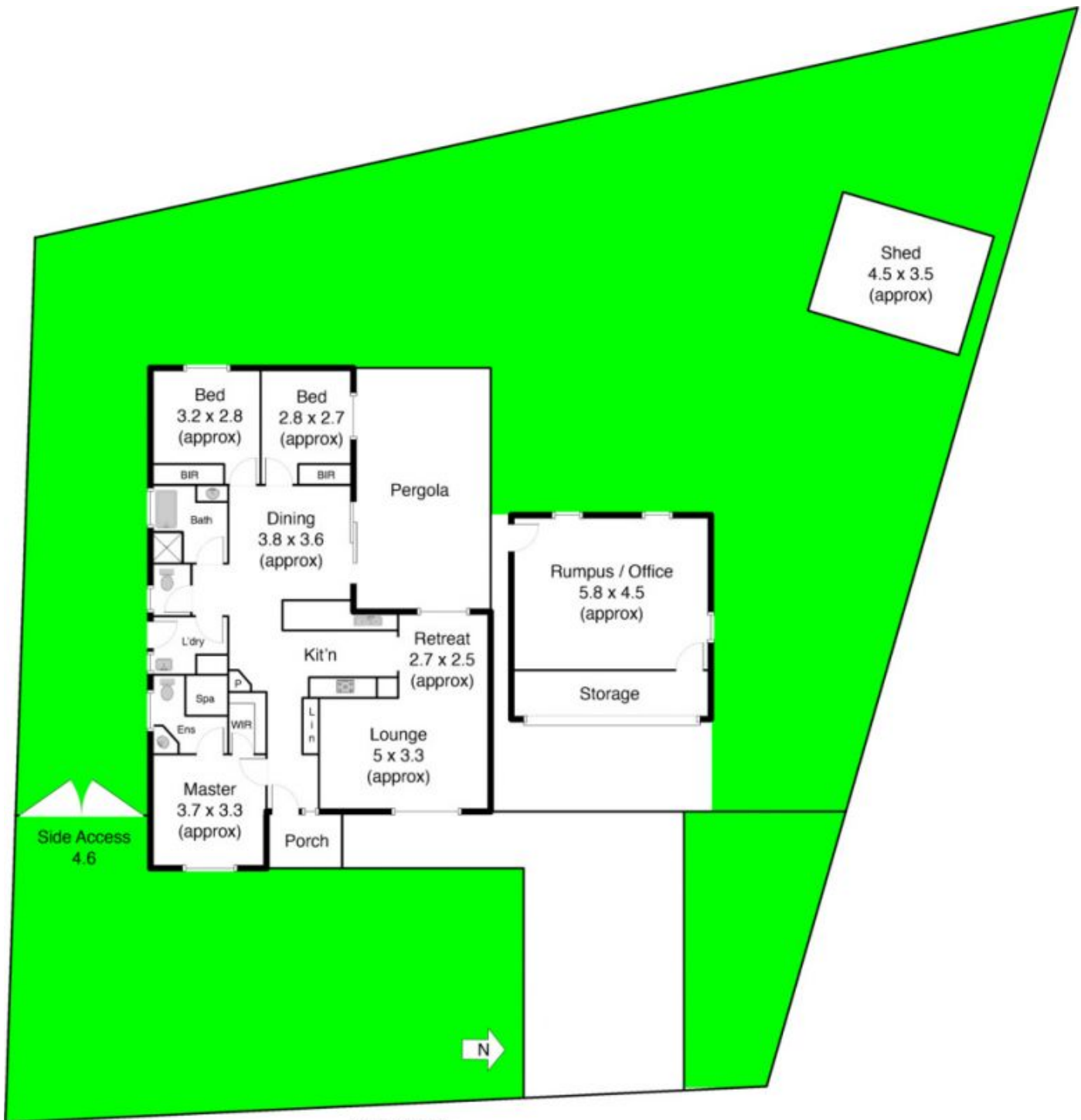

Shed  
4.5 x 3.5  
(approx)

Alkemade Dr