



3 Wetherby Place MELTON WEST VIC

4 2 2

Well located just off Westlake drive is this spacious four bedroom home. The main bedroom features ensuite and walk in robe, all other bedrooms with built in robes. Two separate living areas located at either end of the house, and a large modern and functional kitchen, complete with stainless steel appliances and dishwasher. Additionally, ducted heating, alarm system and modern floor plan, all complement this property. Externally there is a double car garage with remote roller door with rear access situated on a 629m² (approx.) allotment. All this Located in one of Melton's most sort after estate, this one could be all you are looking for. Call now for an inspection.

Land Size : 629 sqm
View : <https://www.ypa.com.au/7398948>



Vickie Ramon
0403 194 621

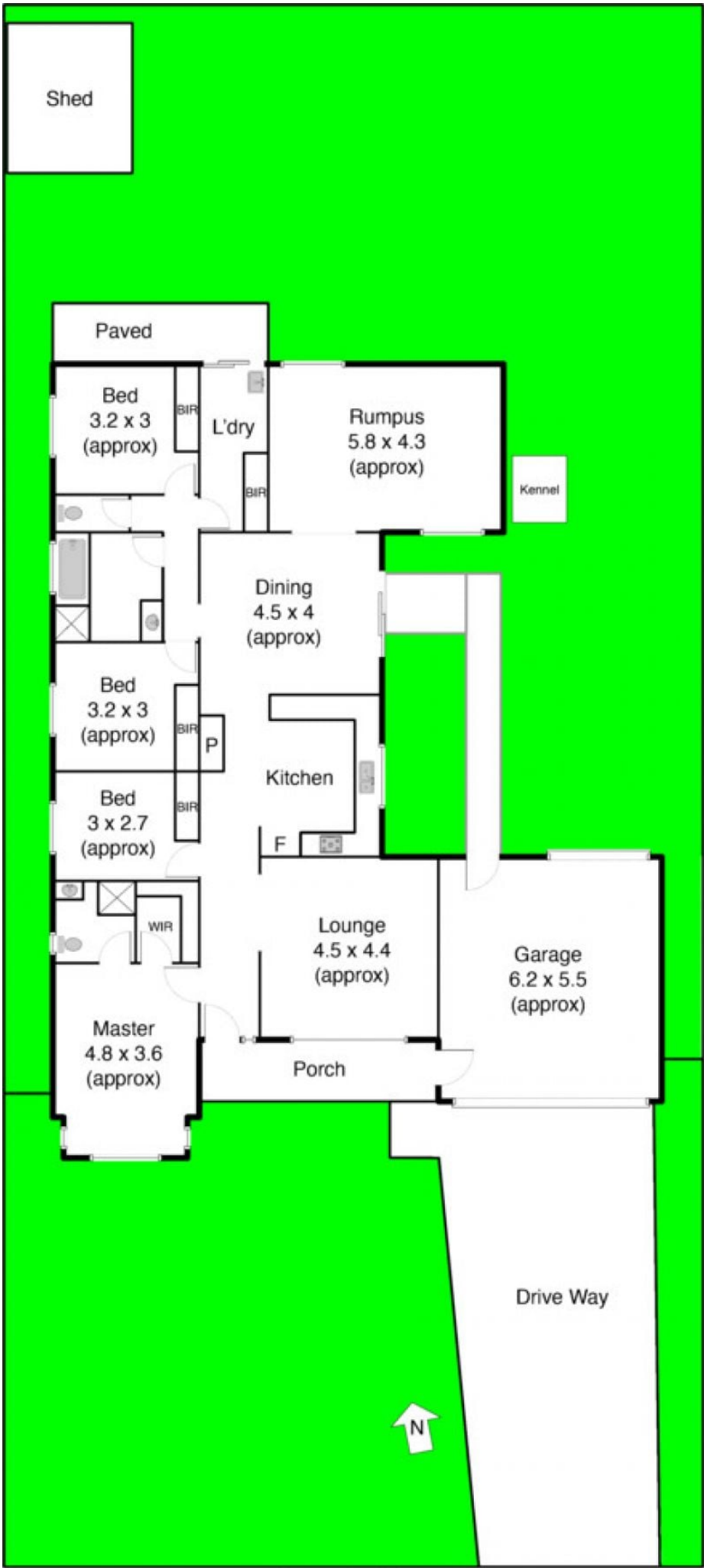

Wetherby Place