



9 Borrowdale Road MELTON WEST VIC

3  2  2 

Brilliantly situated in a popular part of Melton West this ideal residence is what you have been waiting for. Comprising of three large bedrooms master with walk in robe and full ensuite, this fabulous design home includes formal and informal living zones. Appointed with a long list of extras including gas ducted heating and split system cooling, stainless steel appliances, double garage with side access, undercover pergola area perfect for entertaining all year round. Situated on a fantastic & rare allotment of 830m² (approximately) with no easements this immaculate home is sure to impress. Avoid disappointment and act quickly, as the possibilities are endless with this allotment.

Land Size : 830 sqm

View : <https://www.ypa.com.au/7398938>



Shane Spiteri
0488 980 115

9 Borrowdale Road, Melton West

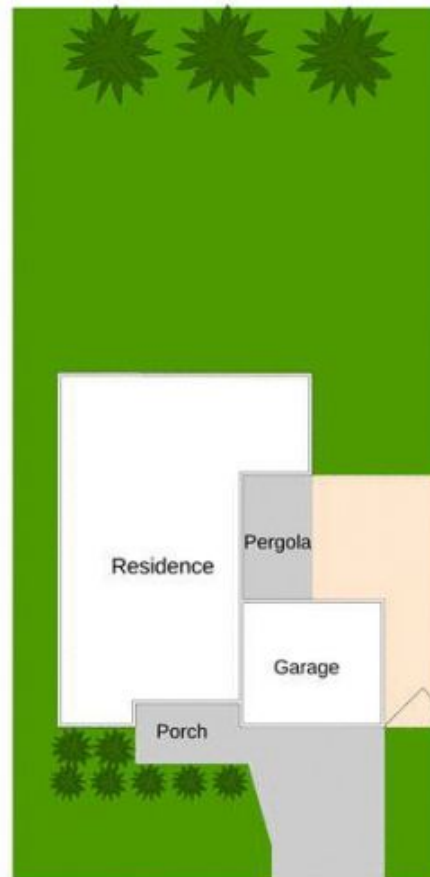
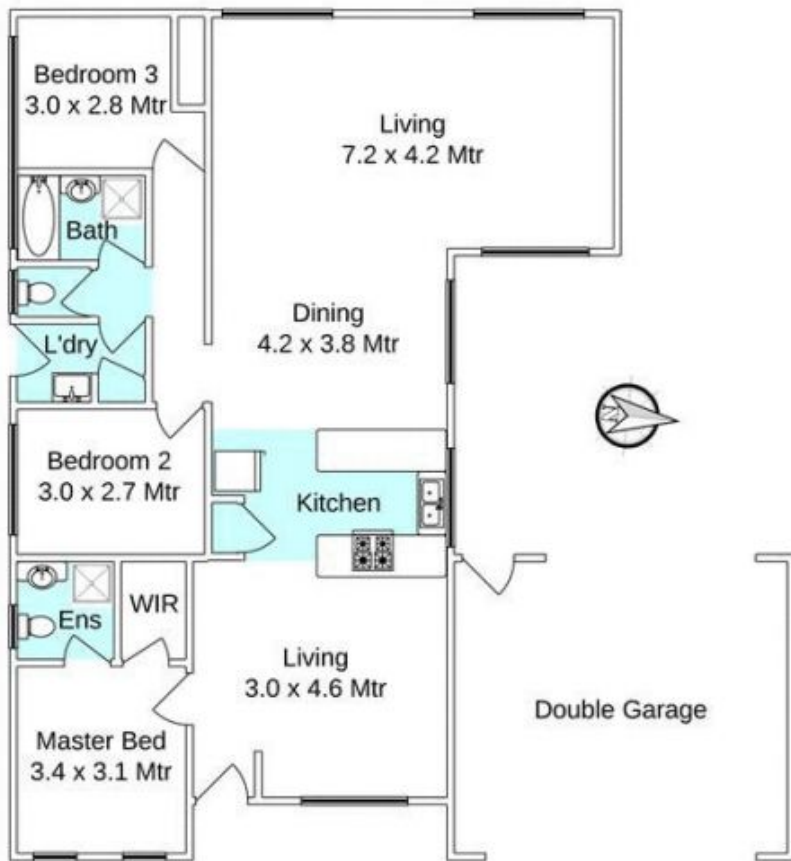

Whilst every precaution has been taken to establish the accuracy of the above information, Prospective buyers are advised to make their own enquiries.