



52 Sovereign Boulevard MELTON WEST VIC

4 2 3

This amazing home boasts an abundance of features with formal & informal living zones flowing through to the large centralised kitchen & meals domain. A large family room & oversized rumpus to the rear of the home allows plenty of accommodation for the entire family. Comprising of 4 spacious double bedrooms with mirrored robes. The master encompasses a full ensuite, including double vanity and spa bath, whilst the central bathroom services the remaining bedrooms. The quality is clear throughout this grand home with the stunning spacious kitchen including stainless steel appliances, stone bench tops and ample cupboard space whilst overlooking open plan living and dining area. Other features include gas ducted heating & evaporative cooling, ample storage and triple car garage with internal and drive through access plus much more! Moving outside just gets better as all the hard work has been completed with the stunning under roof line alfresco,

Land Size : 804 sqm

View : <https://www.ypa.com.au/7398927>



Shane Spiteri
0488 980 115

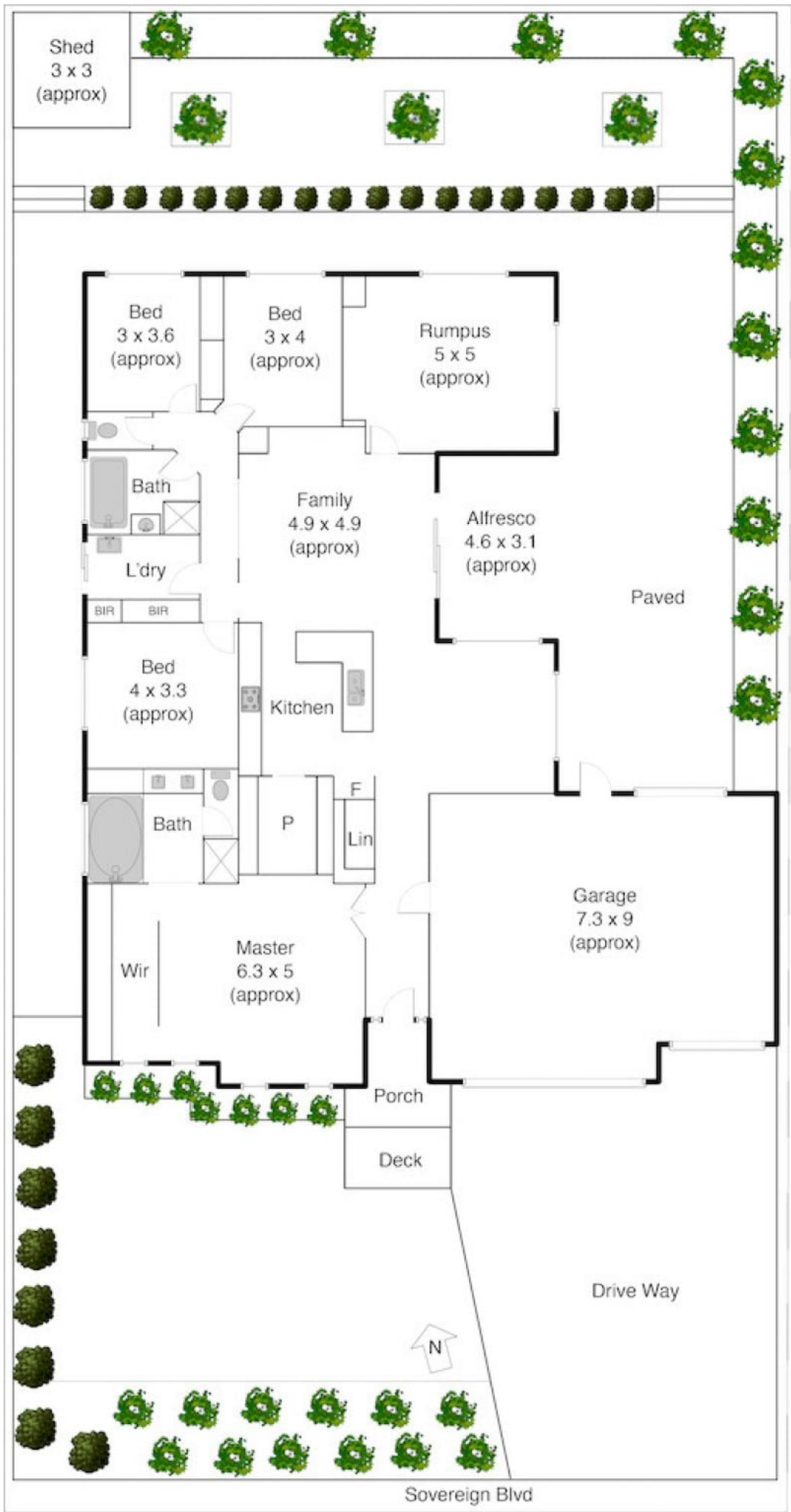

Sovereign Blvd