



2/306 Melrose Drive Tullamarine VIC

3 1 2

Ideal for first home buyers, investors, or downsizers and bigger than it looks! Perfect as is, with room for some TLC or full renovation.

The well-appointed floor plan ensures space for every zone to truly impress. Enjoy a spacious living/formal dining area with external access, bright kitchen and meals offering an abundance of cupboard space, pantry, built in microwave, oven & griller. The rest of the home comprising of 3 generous sized bedrooms, carpeted, all with BIR, central bathroom with shower, bath and vanity, separate toilet, and full-sized laundry.

Within walking distance to local amenities such as medical facilities, public transport, Tullamarine Primary School, restaurants, cafes, and minutes away from major freeways and Melbourne Airport.

Price : \$ 599,000
Land Size : 437 sqm
View : <https://www.ypa.com.au/7397962>



Jake Lisner
0437 399 908

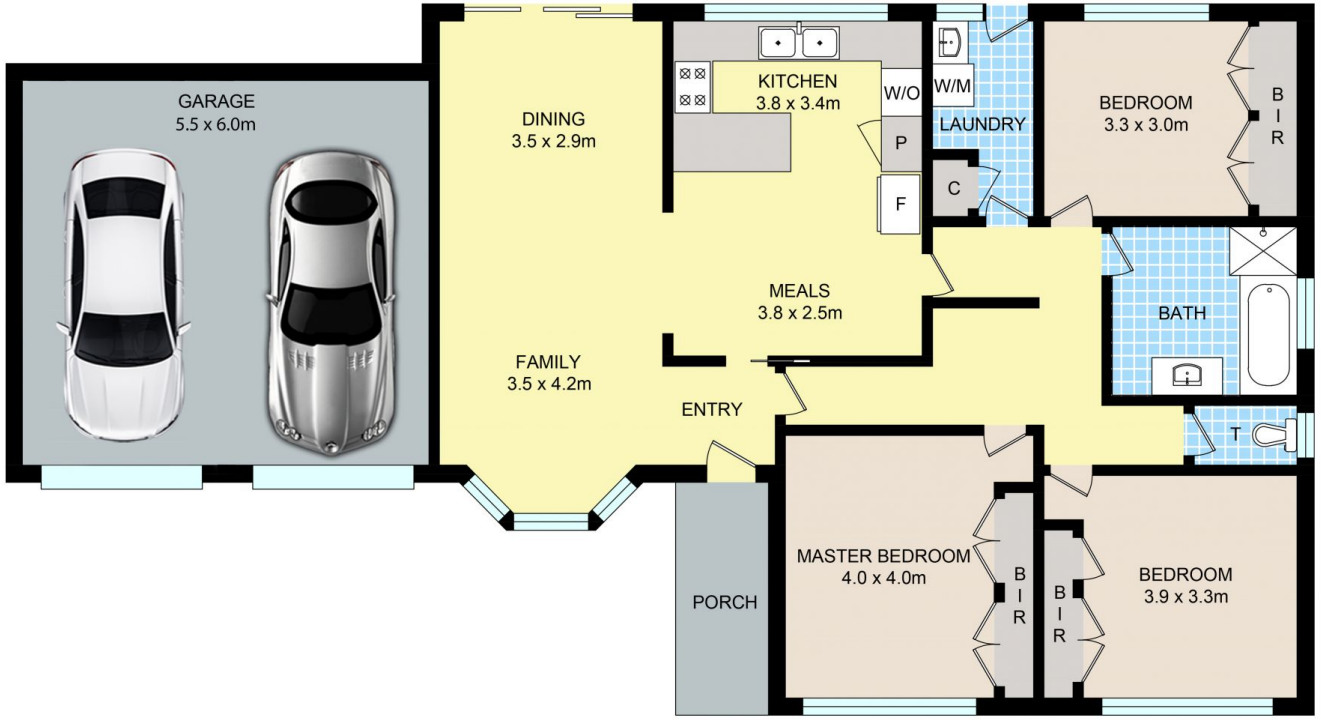

2/306 MELROSE DR, TULLAMARINE

Disclaimer: Floor plan is for marketing purposes and is to be used as a guide only. Measurements are approximate and for illustrative purposes. Interested parties should make and rely on their own enquiries or refer to contract drawings for more accurate information.