

## 104/82 Epping Road Epping VIC

1 1 1

Situated in the now established Waratah Gardens Estate of Epping, this over-sized one-bedroom apartment is perfect for those looking for a first home or investment that is positioned close to the amenities of Epping. Only a short stroll to bus stops taking you down to Epping Station and Epping Plaza this apartment has the long-term accessibility that will last for years.

**Price** : \$ 305,000

**View** : <https://www.ypa.com.au/7397891>

Featuring;

- Bedroom with mirrored built in robes
- Open plan, kitchen, living, dining area walking straight to the balcony
- Kitchen with stainless steel appliances
- Bathroom with separate bathtub and shower
- Tiled private balcony



**Jeremy Pate**  
**0428 085 280**

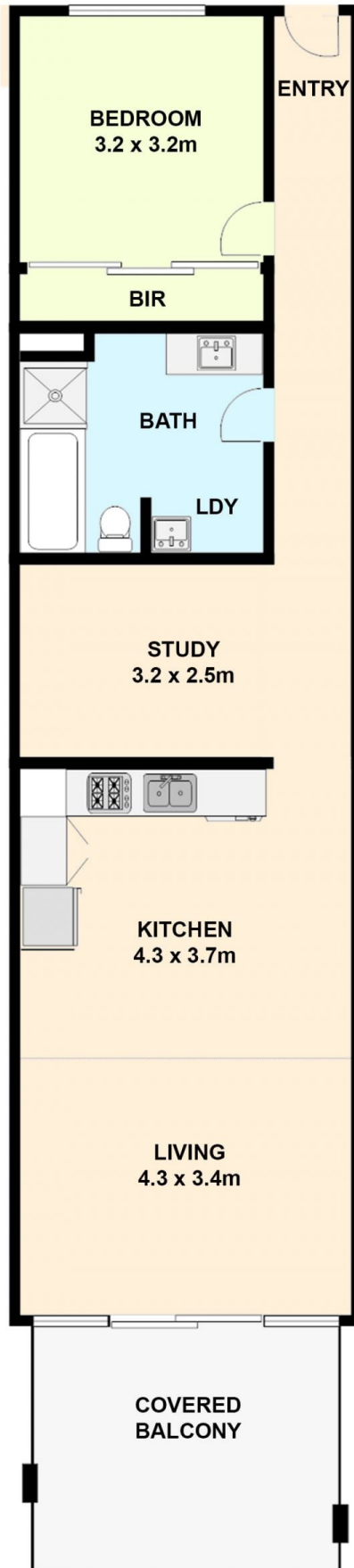

**102/82 EPPING ROAD, EPPING**

*All data and dimensions shown in this sketch are approximate.*

