



104/86 Epping Road Epping VIC

1 1 1

Situated in the now established Waratah Gardens Estate of Epping welcomes an instantly appealing supersized 1-bedroom apartment with BIR and connecting bathroom/laundry, study with flexibility for multiple uses, living area with balcony access, city like views and a well appointment kitchen and dining area offering open-plan living, stainless steel appliances and an abundance of cupboard space!

Simply the perfect home for a first home buyer or investor looking for a lifestyle that provides convenience and comfort with the luxuries of being a short distance to Epping's train station, Epping plaza and local amenities such as grocery stores, medical facilities, schools, restaurants and much more!

Further features include: secure entrance with video

Price : \$ 280,000

View : <https://www.ypa.com.au/7397880>



Jeremy Pate
0428 085 280

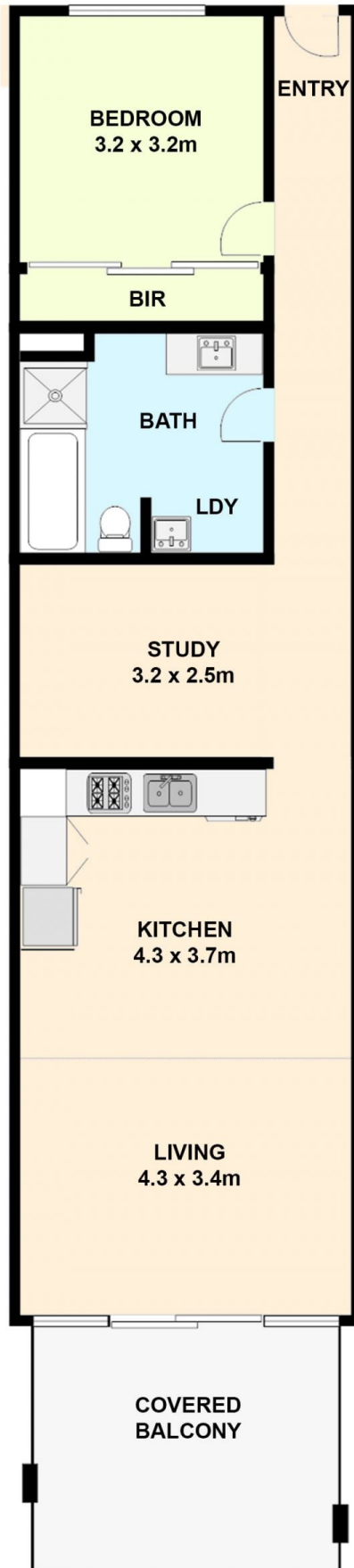

102/82 EPPING ROAD, EPPING

All data and dimensions shown in this sketch are approximate.