

31 Katunga Crescent Broadmeadows VIC

3 1 1

Situated in a convenient location, with schools, transport and shops close by, this well priced home is an opportunity not to be missed. On a great sized 677sqm(approx) allotment offering 3 bedrooms, a great sized lounge, original kitchen with meals area, central bathroom, and laundry. The talking point is the incredible views overlooking Broadmeadows Valley Park whilst you enjoy your morning coffee on the outdoor patio, don't let this opportunity pass you by! Featuring hardwood flooring, gas heating, lock up garage, under house storage and maintained gardens?. This is not one to be missed!

Price : \$ 565,000

Land Size : 676 sqm

View : <https://www.ypa.com.au/7397846>



Luke Albioli
0403 700 003

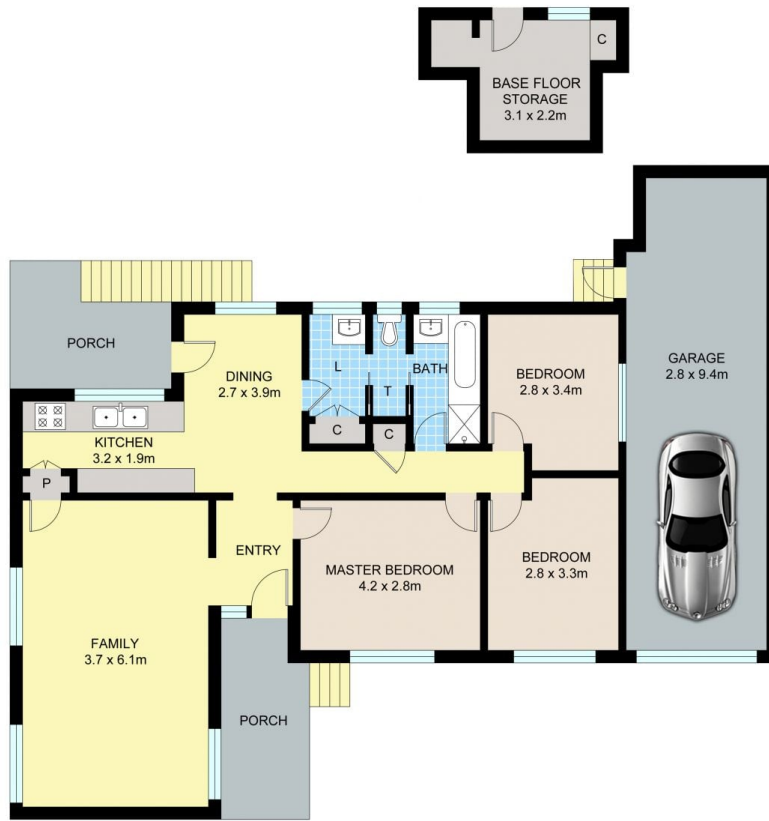

31 KATUNGA CRES, BROADMEADOWS

Disclaimer: Floor plan is for marketing purposes and is to be used as a guide only. Measurements are approximate and for illustrative purposes. Interested parties should make and rely on their own enquiries or refer to contract drawings for more accurate information.