

102/82 Epping Road Epping VIC

1 1 1

Situated in the now established Waratah Gardens Estate of Epping, this oversized one-bedroom apartment is perfect for those looking for a first home or investment that's positioned close to the amenities of Epping. Only a short stroll to bus stops taking you down to Epping Station and Epping Plaza this apartment has the long-term accessibility that'll last for years.

Price : \$ 299,000

View : <https://www.ypa.com.au/7397770>

Featuring;

- Bedroom with mirrored built in robes
- Open plan, kitchen, living, dining area walking straight to the balcony
- Kitchen with stainless steel appliances
- Bathroom with separate bathtub and shower
- Tiled private balcony



Jeremy Pate
0428 085 280



Luke Albioli
0403 700 003

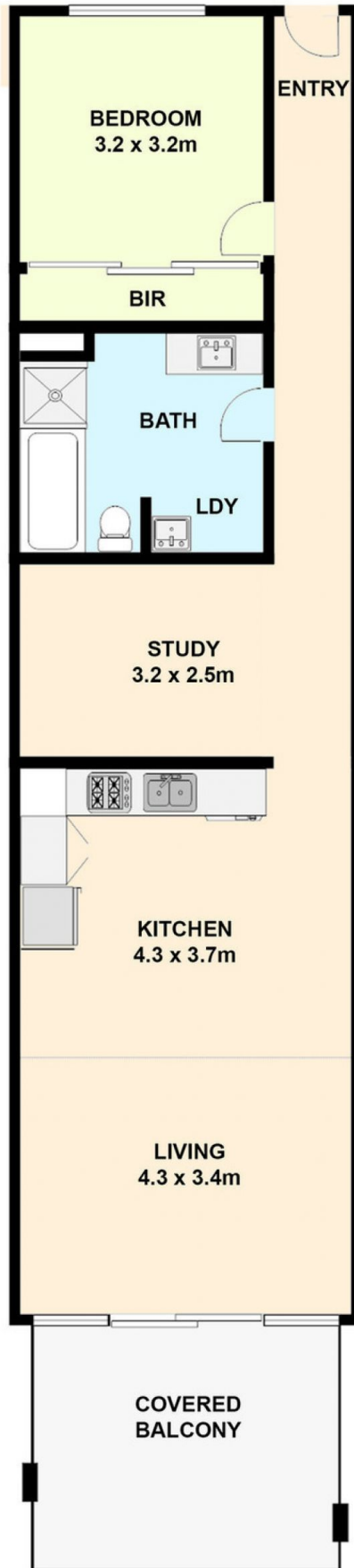

102/82 EPPING ROAD, EPPING

All data and dimensions shown in this sketch are approximate.