



## 13 McKinley Drive ROXBURGH PARK VIC

3  2  3 

This unique townhouse, in the perfect location in Roxburgh Park is sure to leave a lasting impression! With no body corp and being located right next to schools, shops, parks and public transport there is no location more coveted than right here!

**View :** <https://www.ypa.com.au/7397486>

Features of this home include:

- Open plan living, kitchen and dining
- Kitchen featuring SST appliances with an adjoining open pantry area
- Three bedrooms with BIR, Master featuring WIR and full ensuite
- Security cameras covering the front and rear of the property
- Main bathroom with additional toilet downstairs
- Outdoor entertaining area
- Rare and coveted townhouse with a three car garage

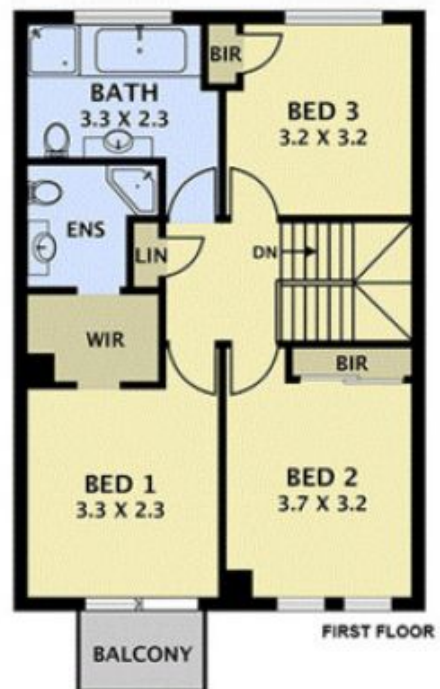
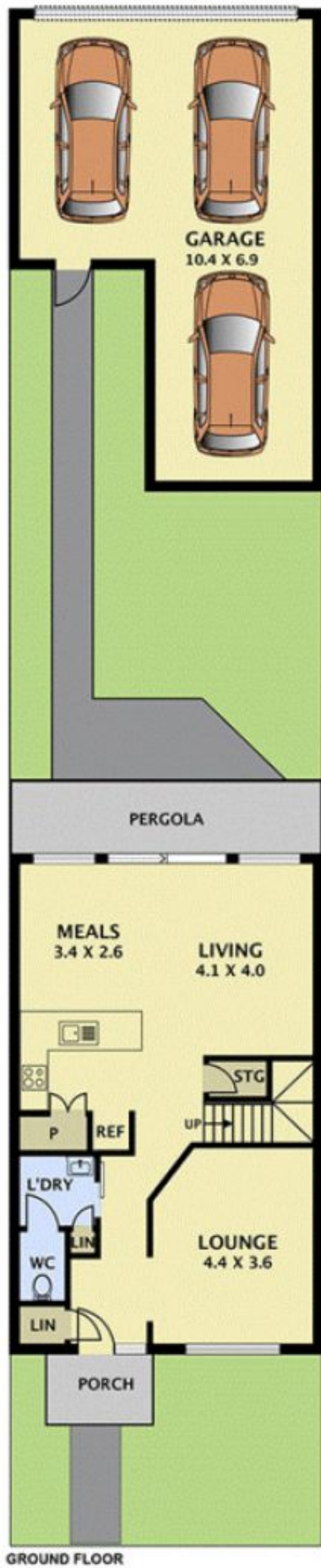

Disclaimer. Please note plans are indicative only and not drawn to exact scale. All dimensions are approximate. Potential buyers view the property in person.