



## 21 James Street Dromana VIC

3  2 

ORIGINAL CLASSIC 60'S ERA BEACH HOUSE ON APPROX. 1420 m2 PRIME LAND

**Price** : \$ 1,625,000

**Land Size** : 1420 sqm

**View** : <https://www.ypa.com.au/7395465>

UP TO 6 MONTHS SETTLEMENT AVAILABLE ON REQUEST

Inspections by appointment. Please call or text Elke mobile 0423 211 315

This home will delight with its fantastic potential for immediate use as a holiday home or for permanent living until you have finalised your plans for future development STCA.



**Elke Remscheid**  
0423 211 315

Featuring:

? Pleasant views with several bay glimpses from the large



Upper Floor



Lower Floor

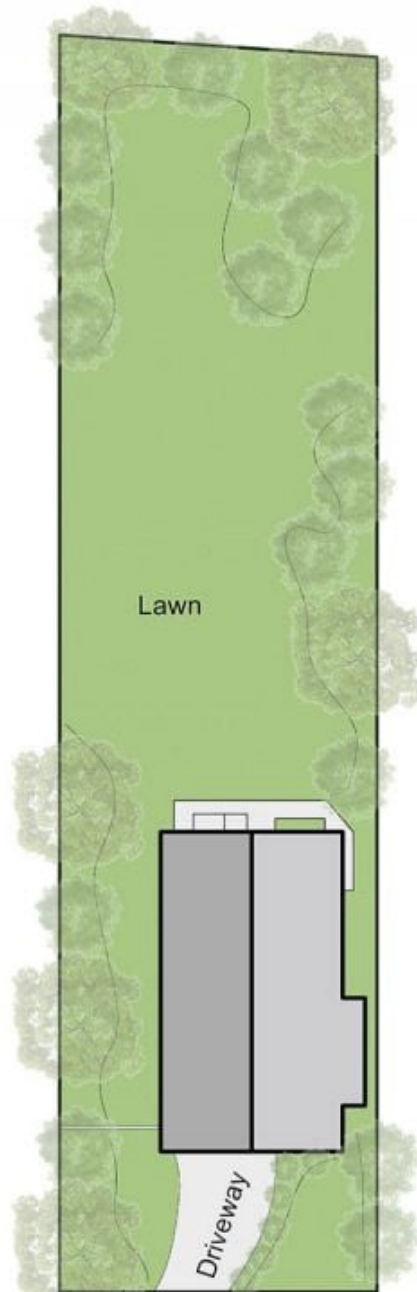

Site Plan

## 21 James St, Dromana

This floorplan is for illustration purposes only and no warranty is given to its accuracy. Purchasers are advised to carry out their own investigations. Produced by realtywriters (03) 5970 2222