



1/6 Lyme Court Capel Sound VIC

3  1  1 

Inspections by appointment. Please call Elke mobile 0423 211 315

Price : \$ 490,000

View : <https://www.ypa.com.au/7395417>

This solidly built & newly renovated home is situated in a quiet and leafy court, with the VERN WRIGHT RESERVE, the SANCUARY PARK RESERVE and the TRUEMANS ROAD RECREATION RESERVE all within a short walk. The BEACH is in reach within a 3-minute drive or 10-minute walk (approx.)

Features include:

- ? 3 bedrooms all with built in robes
- ? Split system heating & cooling to all bedrooms & living area
- ? Kitchen with stone benchtops, gas cooking, dishwasher & plenty of storage



Elke Remscheid
0423 211 315

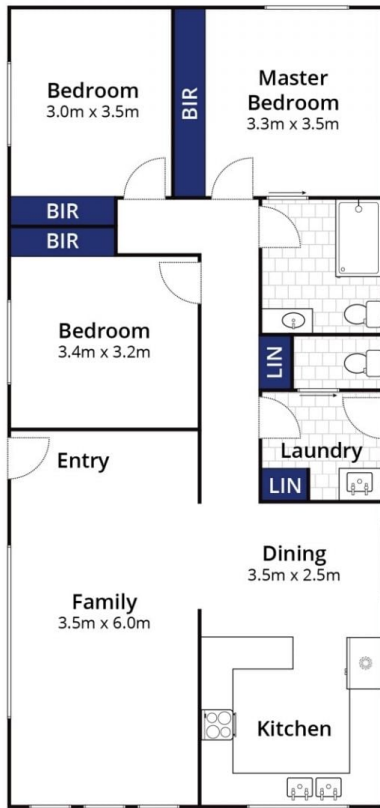

Ground Floor

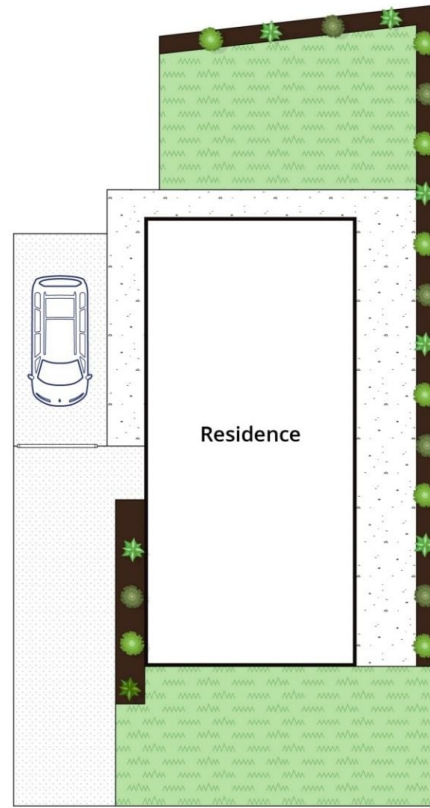

Site Plan

Approx House Area 104m²
Approx Land Area 340m²

Whilst bwr.com.au has made every attempt to ensure the accuracy of the floor plan contained here, measurements are approximate and no responsibility is taken for any error, omission, or mis-statement. This plan is for illustrative purposes only.

1/6 Lyme Court, Capel Sound

